

TGC

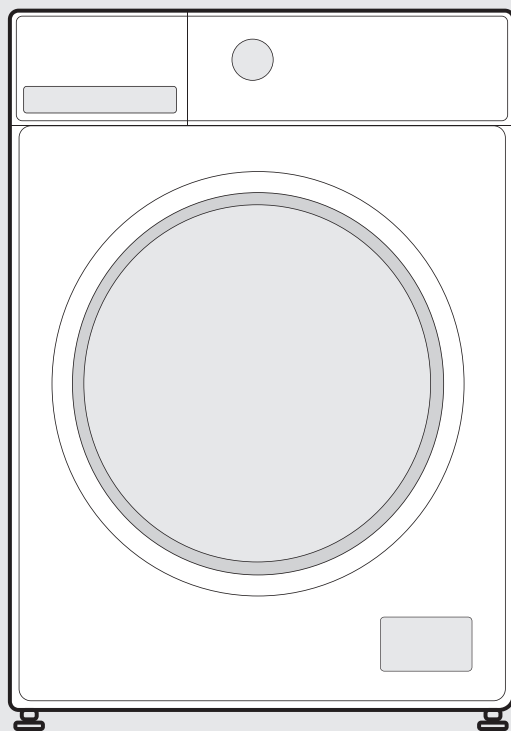

洗衣乾衣機

用戶手冊

型號：TWD860

警告通知：使用本產品前，請仔細閱讀本手冊，並妥善保存以備日後查閱。

產品更新時，其設計及規格如有更改，恕不另行通知。

詳情請諮詢銷售代理或製造商。

上圖內容僅供參考。請以產品實際外觀為準。

恭喜您入手新機！

本用戶手冊將幫助您發現機器的所有優點，並按照自己的方式進行使用。

 我們強烈建議您在首次使用洗衣乾衣機前，細閱本使用說明書。本說明書載有重要的安全指引，以及有關安裝、使用和維護的資料。正確的使用方式有助提升機器效能、節能環保及確保使用安全，同時可盡量減低運作期間的能源消耗。請妥善保存購買單據，以便日後進行任何保養或維修申請時使用。

本使用說明為一般性指引。這表示：本機部分功能適用，部分功能則可能未支援。我們不斷投入資源以開發和優化不同機器型號。因此，本公司保留隨時更改所有型號及類型之設計、功能及配件的權利，恕不另行通知。

符號說明



危險

該符號表示含有極度易燃的氣體，對人體和健康具有危害性。



電壓警告

該符號表示電壓，對人體和健康有危害性。



警告

此警示詞表示存在中等風險的危險，如未能妥善避免，可能會導致死亡或嚴重受傷。



小心

此警示詞表示風險程度較低的危險，如未能妥善避免，可能會導致輕微或中度受傷。



請注意：

該標語表示其為重要信息（如可能造成財產損失），但不表示危險。



遵守指示

帶有該符號的註釋表示您應仔細閱讀操作說明。



遵守指示

表示維修技術人員只能按照操作說明操作維護本產品。

目錄

1 安全須知	3	4 維護	30
1.1 安全須知	3	4.1 清潔和保養	30
2 安裝	11	清潔機身	30
2.1 產品說明	11	清潔滾筒	30
配件	11	清洗門封和玻璃	30
2.2 安裝	12	清潔進水濾網	31
安裝區域	12	清潔洗滌劑分配器	32
設備開箱	13	清潔排水泵濾網	33
拆除運輸螺栓	13	4.2 故障排除	34
平穩安放機器	14	4.3 客戶服務	35
連接供水管	14	5 技術規格	36
排水軟管	14		
隔音海綿	15		
3 操作	16		
3.1 快速啟動	16		
校準	16		
3.2 每次洗衣前	19		
3.3 洗滌劑分配器	20		
洗滌劑推薦	21		
3.4 控制面板	22		
3.5 顯示屏幕	23		
3.6 程式	24		
3.7 選項	26		

1 安全須知

預期使用

本產品只適用於家居使用，並僅限用於可清洗及烘乾的家用數量紡織品。本設備僅適合室內使用，且不能嵌入式使用。使用時必須遵守本手冊指南。本設備不適用於商業用途。

其他用途均不適用。如因使用不當造成設備損壞或人員受傷，生產商概不負責。

- 本設備適用於家庭和類似應用環境，如：
 - 商店、辦公室和其他工作環境中的員工廚房區域；
 - 農舍；
 - 供酒店、旅館和其他居住類環境的客戶使用；
 - 提供住宿和早餐服務的旅館環境；
 - 大廈內的公共使用範圍。

1.1 安全須知

請仔細閱讀並嚴格遵守以下安全資訊，以最大限度地降低火災或爆炸、觸電的風險，並防止財產損失、人身傷害或生命損失。如未遵守本說明將導致所有保修項目失效。

警告！

該符號及訊號詞的組合表示潛在的危險情況，如不妥善避免，可能導致死亡或嚴重受傷。

小心！

該符號及訊號詞的組合表示潛在的危險情況。如不妥善避免，可能造成輕微傷、財產損失或環境損害。

注意！

該符號及訊號詞的組合表示潛在的危險情況，可能造成輕微傷。

1 安全須知

警告！

觸電危險

- 如果電源線損壞，必須由製造商、其代理服務商或其他具備相關資格的人員進行更換，以避免發生危險。
- 如果機器損壞，除非經製造商、服務代理商或相關的合資格人員進行維修，否則不得操作機器。
- 小心觸電！
- 八歲以上兒童、身體、感官或精神能力受限人士，以及缺乏相關經驗或知識的人士，必須在有人監督及指導下，並在充分理解潛在風險的情況下，方可安全使用本設備。嚴禁兒童玩耍本設備。切勿讓兒童在無人監督的情況下對設備進行清潔和使用後保養操作。
- 請看管好兒童，切勿讓兒童玩耍本設備。
- 三歲以下兒童不得在無人監督的情況下靠近本設備。
- 動物或兒童可能會進入設備。每次操作前檢查本電器。
- 請勿攀爬或坐在設備上。

1 安全須知

安裝位置及周圍環境

- 請將洗滌用品和其他添加劑放置於兒童不能接觸的安全位置。
- 請勿將設備安裝於地毯上。
- 一旦地毯遮蓋設備開口，即可能損壞設備。
- 請勿使設備靠近熱源或受到陽光直射，以避免塑膠和橡膠零件損壞。
- 請勿在潮濕環境，或含有爆炸性或腐蝕性氣體的環境中使用本設備。如果設備漏水或濺水，則應令其在戶外自然風乾。

設備安裝位置前方不得有可以上鎖的門或滑門，洗衣乾衣機鉸鏈門的對面不得有其他鉸鏈門。

- 請勿在溫度低於 5°C 的房間內操作機器。這可能會導致部件損壞。如無法避免低溫情況，請於每次使用後徹底排清機內積水（請參閱「維護－清潔排水泵濾網」），以免因結霜或結冰導致損壞。
- 請勿在設備附近使用易燃噴霧或物質。

1 安全須知

安裝

- 使用設備前，拆除所有包裝材料和運輸用螺栓。如未妥善拆除，可能會導致嚴重損壞。
- 該設備配備一個單進水閥，只能連接冷水。
- 安裝後，必須確保電源插頭位於易插拔的位置。
- 首次洗滌衣物前，應先使設備空轉運行一個完整的程式。
- 使用洗衣乾衣機之前，必須先校準設備。
- 請勿在設備上放置水箱和加熱裝置等重物。
- 必須使用隨設備提供的新軟管，不得重複使用以前的舊軟管。
- 最高進水壓力為 1 MPa。最低進水壓力為 0.05 MPa。

電氣連接

- 確保電源線未纏繞設備，否則可能造成損壞。
- 請將本電器接駁至設有接地裝置的插座，並確保該插座受符合「技術規格」表所列數值的保險絲保護。應由具備資格的電工負責接地安裝。確保按照當地法規安裝設備。
- 必須由具備資格的技師根據製造商指南和當地安全法規進行水電連接。

1 安全須知

警告！

- 請勿使用多個插頭或加長電源線。
- 設備不得使用定時器等外部開關裝置，也不得接入定期開關電路。
- 如果周圍有易燃氣體，請勿拔出電源開關。
- 切勿用濕手插拔開關。
- 插拔開關時，請握住開關，切勿拉扯電源線。
- 如果不使用設備，請拔下電源。

水管接頭

- 檢查供水管、水龍頭和排水軟管的連接處是否因水壓變化而出現問題。如果連接鬆動或漏水，則關掉水龍頭，然後進行維修。
- 待具備資格的人員將所有軟硬管連接妥當後，方可使用設備。
- 設備運行期間，玻璃門可能會變得很熱。機器運行時，請讓兒童和寵物遠離機器。
必須妥善安裝並保護進出水軟管。
- 否則可能發生漏水。
- 設備中有水時，請勿拆除排水泵濾網。水量過大可能會導致漏水，水溫過高可能會導致燙傷。

1 安全須知

使用和維護

⚠ 警告！

- 乾衣程式結束前，請勿關閉洗衣乾衣機。如果必須關閉，請務必快速取出衣物並將其展開，以使熱氣消散。
- 不得用洗衣乾衣機清洗用工業化學製劑清潔過的物品。有爆炸的風險。
- 請勿使用易燃、易爆或有毒溶劑。汽油和酒精等不得用作洗滌劑。只能選擇適合機洗的洗滌劑。
- 清空所有衣物口袋。像硬幣、胸針、釘子、螺絲、石頭等銳利和堅硬的物品可能對本設備造成嚴重損壞。
- 使用設備前，取出口袋裏的打火機、火柴等物品。手洗過的物品放入設備前需徹底沖洗乾淨。
- 請勿用設備烘乾未經洗滌的衣物。
沾有食用油、丙酮、酒精、石油、煤油、去污劑、松節油、蠟和除蠟劑等物質的衣物必須先用熱水加大量洗滌劑清洗，然後才能烘乾。
- 本設備不能用於烘乾帶有泡沫橡膠（乳膠海綿）、防水織物、橡膠背襯物品，以及帶有泡沫橡膠墊的衣物或枕頭。
- 如需使用織物柔順劑或類似產品，請遵循使用建議。
- 切勿強行開門。
- 程式結束後，門將快速解鎖。

1 安全須知

- 切勿大力關門。如果發現關門困難，請檢查衣物是否放置妥當。
- 清潔和維護設備前，以及每次使用結束後，請拔下設備電源並關閉水龍頭。
- 請勿向設備潑水進行清洗。小心觸電！
- 為避免危險，只能由製造商、其代理服務商或其他具備相關資格的人員進行維修。
- 如因未授權人員干預導致損壞，生產商概不負責。

運輸

移動設備時的重要步驟

- 拔下設備插頭，關閉進水龍頭。
- 檢查門和洗滌劑分配器是否關好。
- 從房屋裝置上拆下供水管和排水軟管。
- 將設備中的水完全排出（參見 [維護 — 清潔排水泵濾網]）
- 重要提示：重新安裝設備背面的 4 顆運輸螺栓。
- 該設備較重。運輸時需注意安全。提起設備時，請勿抓握設備的突出部分。請勿將洗衣機門當作把手。

1 安全須知

環境

舊家電處置

（僅限歐盟國家）

本電器標有符合歐洲 2012/19/EU 關於廢電器電子設備（WEEE）的指令。該指令提供了歐盟範圍內廢棄設備的回收和再利用框架。



帶有該符號的設備不應作為家居垃圾處理！

作為製造商，我們確保在產品責任範圍內對廢棄設備進行環保處理和回收。我們的產品已在電器及包裝管理機構註冊。關於收集和處置的詳情，請聯絡您所屬的地方當局、市議會或（專業）零售商。在開發

新設備時，我們已注意到所使用材料的高度可回收性。透過回收系統實現高回收率，以減輕堆填區和環境負擔。透過共同努力，我們為環境保護作出了重要貢獻。

型號	洗衣 / 乾衣容量
TWD860	8.0/6.0kg

2 安裝

■ 2.1 產品說明

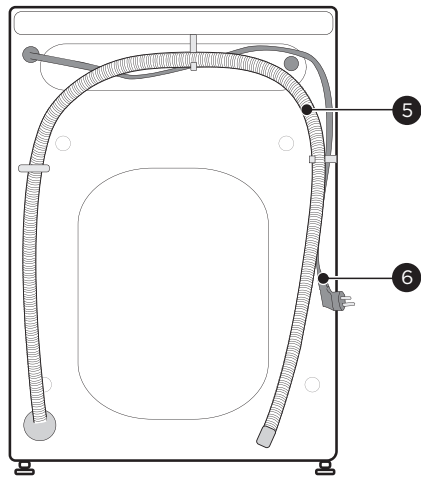
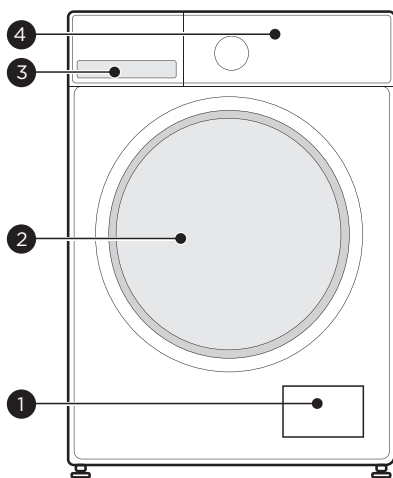

1 檢修板

2 門

3 洗滌劑分配器

4 控制面板

5 排水軟管

6 電源線



注意！

- 產品圖片僅供參考，請以實物為準。

配件

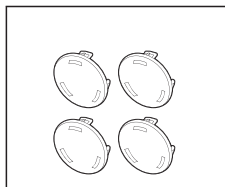

4 個蓋帽



1 根供水管（冷水）



1 份用戶手冊



隔音海綿（選配）

2 安裝

■ 2.2 安裝

 自行安裝所需工具（不包括）

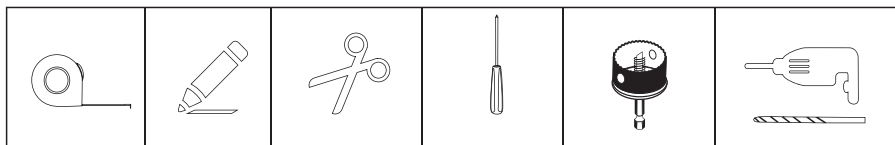

安裝區域

警告！

- 為避免設備晃動，請務必確保安裝穩定性。
- 確保機器處於水平和穩定狀態。
- 確保產品未壓住電源線。
- 建議機器與牆壁保持圖示最小距離。

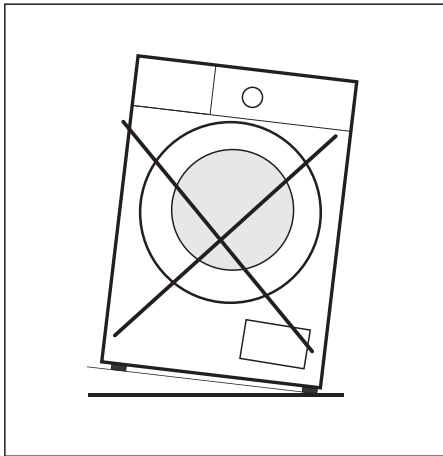
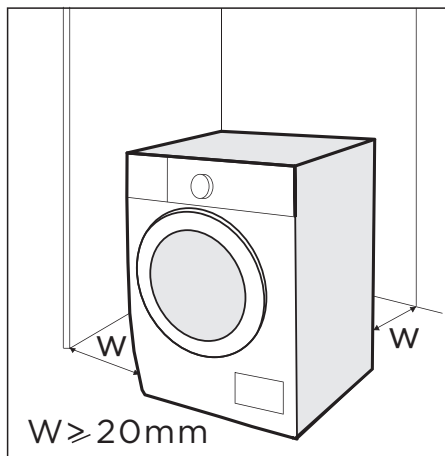

在安裝機器之前，應選擇具有以下特徵的位置：

1. 堅硬、乾燥、平整的地面
2. 避免直射陽光
3. 充分通風
4. 室內溫度高於 5°C
5. 請遠離煤氣爐、燃氣熱水爐等熱源擺放。

2 安裝

設備開箱

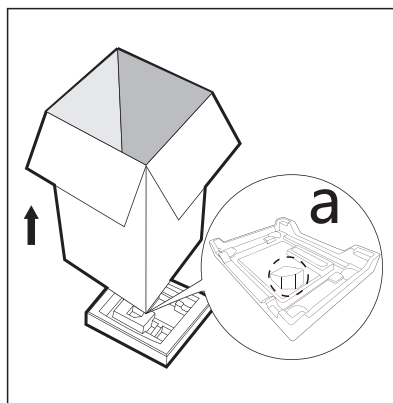

⚠ 警告！

- 包裝材料（如塑膠膜、填充泡沫等）可能會對兒童造成危險。
- 可能會造成窒息！請避免兒童接觸包裝材料。

1. 拆開紙箱和聚苯乙烯泡沫塑料包裝。
2. 請抬起洗衣乾衣機，並移除底部包裝材料。請確保小三角形泡沫（a）已連同底部包裝一併移除。如未有取出，請將機身側放，並以人手將其移除。
3. 移除固定電源線和排水軟管的膠帶。
4. 從滾筒上拆下供水管。

拆除運輸螺栓

⚠ 警告！

- 使用設備前，必須取下背面的運輸螺栓。

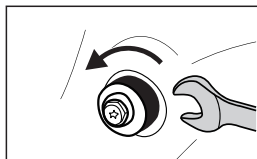

使用扳手鬆開 4 顆運輸螺栓。

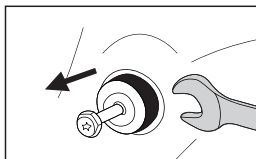

拆下螺栓以及橡膠件，並將它們妥善保存，以備將來使用。

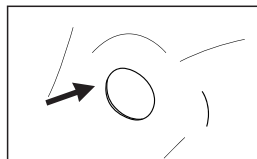

用蓋帽堵住孔口。

2 安裝

平穩安放機器

警告！

- 必須擰緊全部四個支腳的鎖緊螺母，使其牢固連接到箱體。

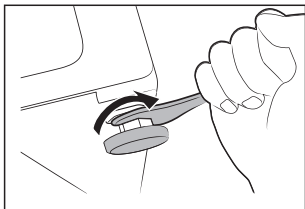

1. 鬆開鎖緊螺帽。
2. 扭動支腳，直至接觸地面。
3. 調校支腳，並用士巴拿鎖緊螺帽。使用水平儀確保洗衣機放平。

連接供水管

警告！

為避免漏水或損壞，請按本章指南操作。

- 請勿扭結、擠壓或更改供水管。

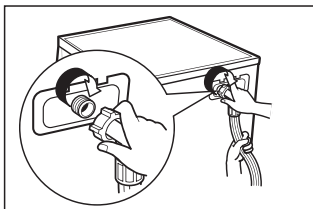

按照指示，將供水管連接到進水閥和冷水龍頭上。

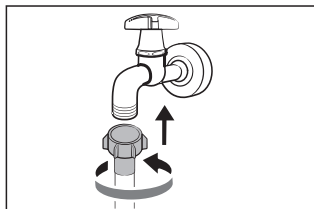

注意！

- 手動連接，請勿使用工具。檢查連接是否緊密。

排水軟管

警告！

- 切勿扭結或延長排水軟管。
- 排水軟管應妥善放置，否則可能導致漏水，進而造成損壞。
- 請勿拆卸排水軟管的卡扣。

2 安裝

排水軟管的末端有兩種放置方式：

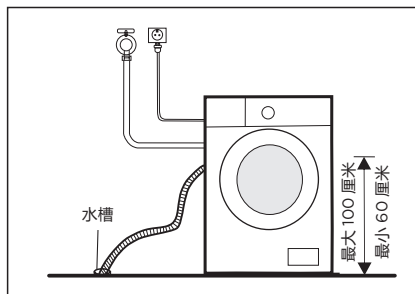

1. 將排水軟管放入水槽。

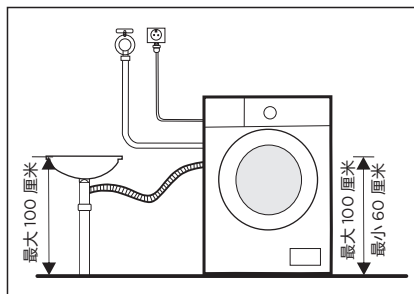

2. 將排水軟管連接到水槽的排水支管上。



注意！

- 圖片僅用於說明安裝時的高度要求。

隔音海綿(選配)



注意！

- 隔音海綿為選擇性配件，按客戶要求安裝及另收安裝費。它可以有效降低機器工作時產生的噪音，為您提供一個更加清淨的生活環境。

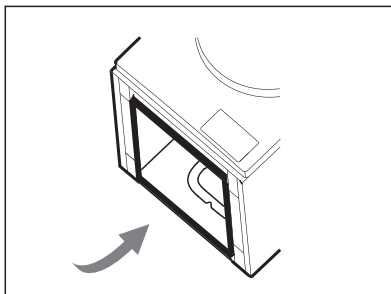
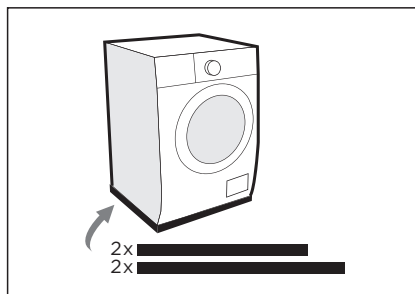

1. 請將機器放置於地板上，並在機器與地板之間墊上泡棉或衣物等柔軟物料作保護；
2. 請將兩塊長海綿貼於機器較長的一側底邊，並將兩塊短海綿貼於較短的一側底邊。

3 操作

■ 3.1 快速啟動

⚠ 小心!

- 洗滌前，請確保洗衣乾衣機安裝妥當。
- 設備在出廠前已經過全面檢查。爲了去除任何殘留水並中和潛在的氣味，建議在首次使用前清潔設備。為此，建議運行「滾筒清洗」或其他可選溫度為 90°C 的程式來清潔內滾筒。注意此時切勿將衣物和洗滌劑放入洗衣機內。

校準

建議進行洗衣乾衣機校準，以確保發揮最佳效能。

設備能夠偵測衣物的載量。此功能可最大程度減少耗能與用水量，從而提升產品效能，為您節省金錢與時間。因此，建議進行設備校準，以達致最佳使用效果。

1. 請從滾筒中取出所有附件，然後關上機門；
2. 請將電源插頭插入插蘇；
3. 開啟洗衣乾衣機電源，同時按住「功能」鍵及「乾衣」鍵約 10 秒，直至顯示 "t19"；

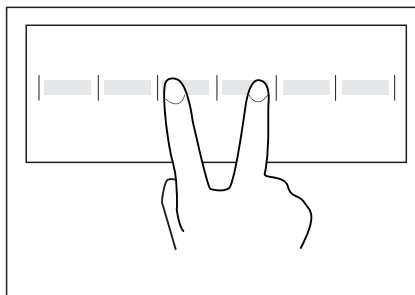

4. 按下【▷||】啟動設備並等待，直到顯示 "****"。

如機器校準成功，屏幕將顯示 "PAS"；若未成功，則顯示 "FAL"。

3 操作

1. 清洗前

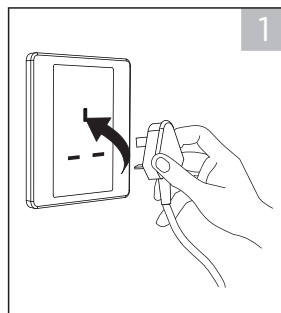

插入電源

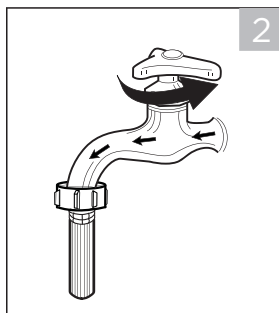

打開水龍頭

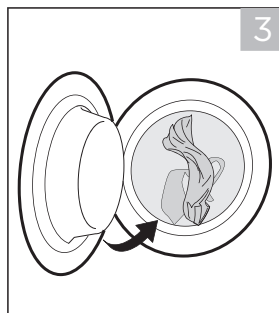

裝入衣物

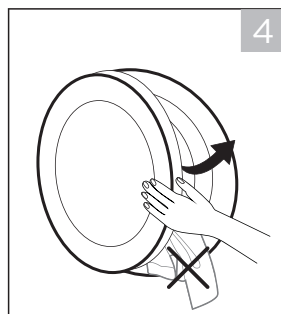

關門

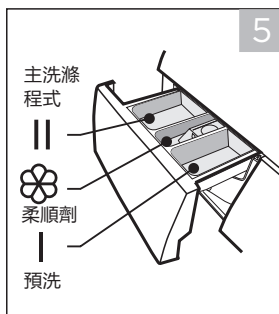

加入洗滌劑

📌 注意！

- 如果選擇了預洗功能，則需要在洗滌劑分配器「盒1」中添加洗滌劑。
- 請勿將洗衣球放入洗滌劑分配器中。
- 關門時，請確保您的衣物沒有夾在密封圈和洗衣機門之間，以防止在使用過程中拉扯和損壞密封圈造成漏水。

3 操作

2. 清洗

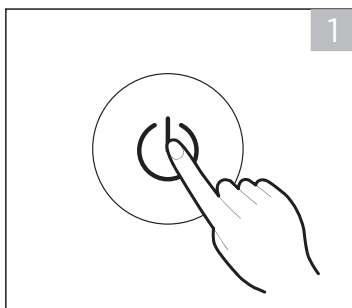

打開電源

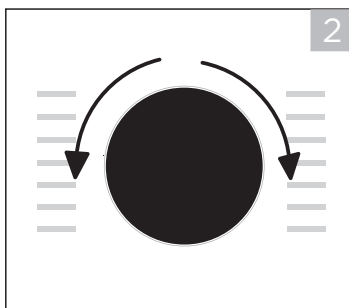

選擇程式

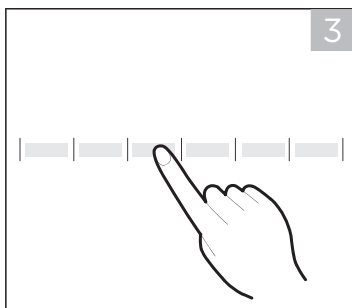

選擇功能或保持預設設定

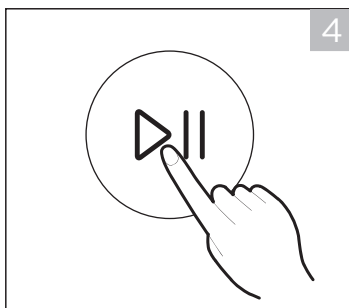

按下開始 / 暫停按鈕啟動程式

注意!

- 1: 如果選擇預設模式，則可以跳過第 3 步。
- 2: 功能按鍵線型圖僅供參考，請以實物為準。

3 操作

3.2 每次洗衣前

- 洗衣乾衣機的使用環境溫度範圍為 5 至 40°C。如果在 0°C 以下使用，進水閥和排水系統可能會受損。如果機器在結冰條件下安裝，應將其轉移到正常的環境溫度下，以確保供水管和排水軟管在使用前能夠解凍。
- 洗滌前，請查看衣物護理標籤和洗滌劑使用說明。請使用適用於洗衣機的無泡或低泡洗滌劑。

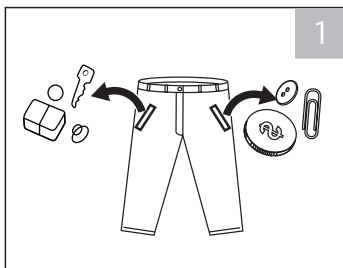

從口袋中取出所有物品

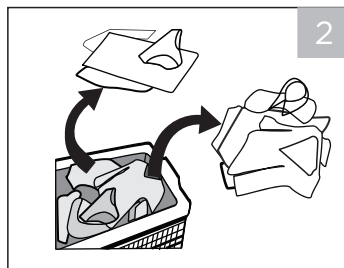

根據顏色和織物類型對衣物進行分類

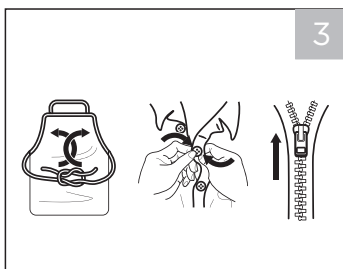

將長帶打結，鈕扣扣好，拉鍊拉上

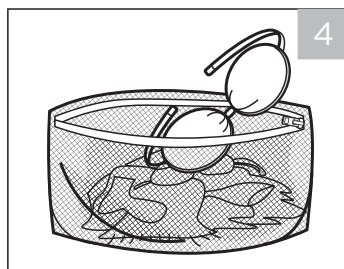

將小件物品放入洗衣袋中洗滌

警告！

- 請勿清洗或烘乾用蠟類、油類、油漆、汽油、酒精、煤油等易燃易爆物質清洗過、洗滌過、浸泡過或塗抹過的物品。
- 洗滌單件衣物容易造成偏心率大。因此，建議在洗滌過程中添加一件或兩件以上的衣物，以便順利脫水。
- 請勿用本設備清洗、脫水或烘乾防水座椅、墊子或衣物。

3 操作

3.3 洗滌劑分配器

- I 預洗
- II 主洗滌程式
- ⊗ 柔順劑
- ☉ 釋放按鈕，拉出分配器

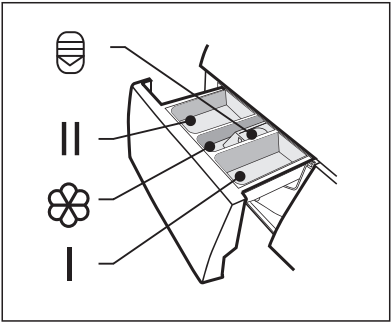

⚠ 小心!

- 選擇預洗功能後，只需在洗滌劑分配器「盒 I」中添加洗滌劑。
- 請勿將洗衣球放入洗滌劑分配器中。

程式	I	II / △	⊗	程式	I	II / △	⊗
棉質	○	●	○	過水及脫水			○
混合布料	○	●	○	羊毛		●	○
嬰兒柔洗	○	●	○	40-60 度節能洗		●	○
20度水溫		●	○	強力洗	○	●	○
滾筒清洗				15分鐘快洗 / 1小時洗乾		●	○
淨脫水				淨乾衣			
洗乾		●	○				

- 必須使用
- 選擇使用

3 操作

洗滌劑推薦

推薦的洗滌劑	衣物和織物類型	清洗程式	洗滌溫度 °C
含漂白劑和螢光增白劑的重型洗滌劑	防沸煮棉或亞麻布製成的白色衣物	棉質，混合布料，強力洗	40/60/90
不含漂白劑和螢光增白劑的彩色洗滌劑	棉或亞麻製成的彩色衣物	棉質，40–60 度節能洗，混合布料，強力洗	冷 /20/30/40
不含螢光增白劑的有色或溫和洗滌劑	易護理纖維或合成材料製成的彩色衣物	20度水溫	冷 /20
溫和洗滌劑	精緻紡織品、絲綢、粘膠織物	羊毛	20/30
羊毛衣物專用洗滌劑	羊毛衣物	羊毛	20/30/40



注意！

- 結塊或粘稠的洗滌劑或添加劑可在倒入洗滌劑分配器之前用一些水稀釋，以免分配器入口堵塞及導致水溢出。
- 請選擇合適類型的洗滌劑，以最大限度地提高清洗性能，減少水和能源的消耗。
- 爲了達到最佳洗滌效果，適當的洗滌劑用量非常重要。
- 如果滾筒未完全裝滿，請減少洗滌劑的用量。
- 務必根據水的硬度調整洗滌劑的用量，如果自來水較軟，請減少洗滌劑用量。
- 根據衣物的髒污程度來配量，較乾淨衣物只需少量洗滌劑。
- 高濃度（濃縮型）洗滌劑的劑量需要特別精確。

以下現象是洗滌劑過量的表現：

- 大量泡沫形成
- 洗滌和漂洗效果不佳

以下現象是洗滌劑用量不足的表現：

- 衣物變灰
- 滾筒、加熱元件和 / 或衣物上積聚水垢

3 操作

■ 3.4 控制面板

型號：TWD860

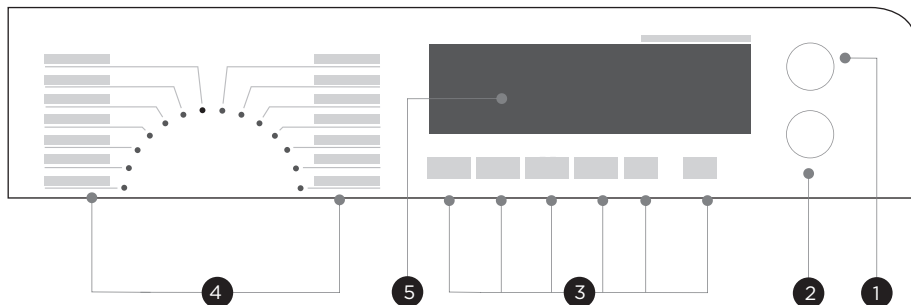

① 開啟 / 關閉

打開和關閉洗衣機。

② 啟動 / 暫停

啟動或暫停程式。

③ 選項

這讓您能夠選擇其他功能。選定後，對應的按鍵將亮起。

④ 程式

可根據洗衣及乾衣類型選擇合適的程式。

⑤ 顯示

顯示屏顯示設定、預計剩餘時間、選項和狀態信息。

3 操作

■ 3.5 顯示屏幕

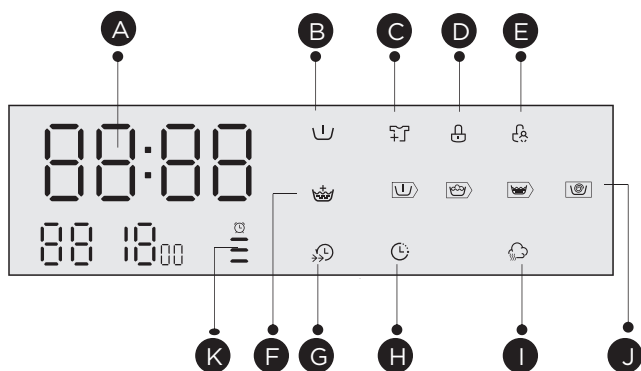

A 顯示

洗衣時間

125

轉速

400

結束

End

延時洗衣時間

2H

錯誤

E30

水溫

30

B 預洗

C 添放衣物

D 門鎖

E 兒童鎖

F 額外漂洗

G 加速洗滌

H 延時洗衣

I 蒸氣護理

J 預洗 - 洗滌 - 漂洗 - 脫水

K 乾衣

3 操作

3.6 程式

可根據洗衣類型選擇合適的程式。

程式

棉質	耐磨紡織品、耐熱紡織品，由棉或亞麻製成。
嬰兒柔洗	清洗嬰兒的衣物，可使嬰兒的衣物更清潔，漂洗性能更好，保護嬰兒皮膚。
混合布料	棉麻織物及合成纖維織物混洗。
20度水溫	可以在 20°C 的標稱溫度下清洗輕度污垢的棉質衣物。
40-60 度節能洗	可以在同一程式內清洗可在 40°C 或 60°C 洗滌的正常污漬的棉質衣物。
15分鐘快洗 /	超短程序，適用於清洗輕微污漬的少量衣物。
1小時洗乾	適用於少量合成衣物或襯衫洗乾，載荷限制 1kg（約 4 件襯衫）。
羊毛	可手洗或機洗羊毛織物或富含羊毛的織物。這種特別溫和的洗滌程式可防止縮水，暫停時間較長（織物在洗滌液中靜置）。
淨脫水	脫水並排水。
過水及脫水	漂洗和脫水衣物，然後排水。
強力洗	爲了提高洗滌效果，延長了洗滌時間。
滾筒清洗	專爲清潔滾筒和管道而設。採用 90°C 高溫殺菌，使衣物洗滌更環保。 執行此程式時，不得添加衣物或其他洗滌品。用戶可根據需要定期運行此程式，使用頻繁建議每月清理。
淨乾衣	根據選擇的模式，烘乾衣物時的溫度會有所不同。乾衣時間會按衣物容量而定。
洗乾	洗衣及乾衣的標準耗能程式。

注意

- 參考您的產品來選擇程式。

3 操作

型號：TWD860

程式	洗衣 / 乾衣容量 (kg)	顯示時間
8.0		
☀ 棉質	8.0/6.0	3:00
☀ 混合布料	8.0/6.0	1:30
☀ 洗乾	6.0/6.0	5:16
☀ 淨乾衣	--/6.0	4:09
20度水溫	4.0/--	1:01
☀ 嬰兒柔洗	4.0/4.0	2:01
滾筒清洗	--	1:18
淨脫水	8.0/--	0:12
過水及脫水	8.0/--	0:20
羊毛	2.0/--	1:07
40-60 度節能洗	8.0/--	3:38
強力洗	8.0/--	1:28
15分鐘快洗	2.0/--	0:15
☀ 1小時洗乾	1.0/1.0	0:58

- 香港能效等級為：I。
能耗測試程式：棉質衣物，溫度：60℃；轉速：1200，其他為預設設定。

3 操作

3.7 選項

程式	預設溫度 (°C)	默認脫水轉速	其他功能
		1400	
棉質	40	1400	🕒, 🏔, 🍷, 🌀, 🌞
混合布料	40	1400	🕒, 🏔, 🍷, 🌀, 🌞
洗乾	40	1400	🕒, 🌞
淨乾衣	-	1200	🕒, 🌞
20度水溫	20	1000	🕒, 🏔, 🌀
嬰兒柔洗	60	1000	🕒, 🏔, 🍷, 🌀, 🌞
滾筒清洗	90	400	🕒
淨脫水	冷	1000	🕒
過水及脫水	冷	1000	🕒, 🏔
羊毛	40	600	🕒, 🏔
40-60 度節能洗	60	1400	🕒
強力洗	40	1000	🕒, 🏔, 🍷, 🌀, 🌞
15分鐘快洗	冷	800	🕒, 🏔
1小時洗乾	冷	1400	🕒, 🌞, 🏔

📌 注意！

- 關於40-60 度節能洗及洗乾程式的最高脫水轉速、程式時間和其他詳情，請參閱產品資訊頁上的內容。
- 該表列出了各程式的可調整選項。

3 操作



延時洗衣

設定延時洗衣功能：

1. 選擇一個程式；
2. 按【延時洗衣】鍵，選擇時間（延時洗衣時間為0-24小時）；
3. 按【啓動 / 暫停】鍵，開始延時洗衣操作。



選擇程式



設定時間



開始

取消延時洗衣功能：

按下【延時洗衣】鍵，直到屏幕顯示 0 小時。應在程式啓動前取消預約。

如果程式已經啓動，則應關閉程式以重置新程式。



預洗

預洗功能可在主程式洗滌前進行一次額外洗滌，適用於洗滌衣物表面的灰塵；選擇時需在洗滌劑分配器「盒 I」中添加洗滌劑。



額外漂洗

選定後，將對衣物進行一次額外漂洗。



加速洗滌

該程式洗滌時間短。



自設程序

記憶常用程式。選擇程式並設定選項後，在開始洗滌前 3 秒按下【水溫】按鈕。預設設定程式為「棉質」。



水溫

按鍵調節溫度

（冷、20℃、30℃、40℃、60℃、90℃）



轉速

按鍵改變轉速。1400:0-400-600-800-1000-1200-1400



蒸氣護理

蒸氣護理功能可選擇「棉質」、「混合布料」、「強力洗」和「嬰兒柔洗」。



注意！

- 當此功能與其他功能組合使用時，需要最後選擇「蒸氣護理」。

3 操作



添放衣物

該操作可以在洗滌過程中執行。滾筒仍在滾動時，滾筒內有大量高溫水。這不處於安全狀態下，並且不能強行打開洗衣機門。長按「啓動 / 暫停」鍵 3 秒重新放入衣物，並開啓中途增加衣物功能。請按照以下步驟操作：

1. 等待滾筒停止轉動。
2. 門鎖解鎖。
3. 添放衣物後關門，然後按下【啓動 / 暫停】按鈕。



長按【啓動 / 暫停】按鈕 3 秒。



重新放入衣物



啓動



小心！

- 當水位超過內桶邊緣或溫度較高時，請勿重新放入衣物。



乾衣

連續按下「乾衣」鍵，選擇乾衣等級：特別乾衣 / 正常乾衣（正常） / 溫和乾衣（柔軟）。

- ☰ 特別乾衣：需要立即穿衣服，可選擇此功能；
- ☐ 正常乾衣（正常）：正常乾衣程式；
- 溫和乾衣（柔軟）：只需稍微乾衣即可；
- 🕒 定時乾衣：選擇此功能，可對衣物進行特定時間的乾衣（30/60/90/120/180 分鐘）。



注意！

- 乾衣提示
 - 在烘乾衣物之前，要徹底脫水。
 - 爲確保正確烘乾，請根據織物類型和烘乾溫度對衣物進行分類。
- 不適合烘乾的衣物
 - 請勿烘乾合成纖維窗簾、羊毛和絲綢、帶金屬嵌件的衣物、尼龍長襪、大型衣物（如厚外套、床罩、被、睡袋和羽絨被）等特別精緻的衣物。
 - 不得烘乾墊有泡棉橡膠或類似泡棉橡膠材料的衣物。
 - 不得烘乾含有定型乳液或髮膠、指甲油或類似溶液殘留物的織物，以避免形成有害蒸氣。

3 操作



兒童鎖

避免兒童誤操作。

Delay
延時洗衣

SpaCare
蒸氣護理

按【延時洗衣】和【蒸氣護理】3 秒，直到蜂鳴器響起。

⚠ 小心！

兒童鎖開啓，程式啓動時，兒童鎖指示燈亮起，顯示屏上「CL」和剩餘時間交替顯示。

按下其他按鈕，兒童鎖指示燈閃爍。程式結束時，「CL」和「結束」在顯示屏上交替顯示。

- 只有長按兩個按鍵才能解除兒童鎖，即便斷電、關機和結束程式也都無法解除。
- 「兒童鎖」將鎖定電源鍵和兒童鎖鍵以外的所有按鍵。
- 請在選擇程式開始洗滌前解除兒童鎖。



蜂鳴器靜音



選擇程式



Speed
轉速



按住【轉速】鍵 3 秒，蜂鳴器靜音。

要啓用蜂鳴器功能，再次按下按鍵 3 秒鐘。

設備將一直保持該設置，直到再次重設。

⚠ 小心！

- 蜂鳴器功能靜音後，聲音將不再被啓動。



注意！

使用計數器

1. 請同時連續按控制面板上的「水溫」和「蒸氣護理」按鈕約 5 秒鐘，開機狀態下設備顯示屏會顯示數字——該數值可以表示設備的使用次數。
2. 同時連續按控制面板上的「水溫」和「蒸氣護理」按鈕約 5 秒，客戶即可恢復正常運作。

4 維護

4.1 清潔和保養

警告！

- 清潔和維護設備前，請拔下設備電源並關閉水龍頭。

清潔機身

對洗衣乾衣機進行適當的維護可以延長其使用壽命。必要時，可用稀釋的非研磨性中性洗滌劑清潔表面。如有水溢出，請立即用毛巾擦掉。切勿使用尖銳物品清洗設備。

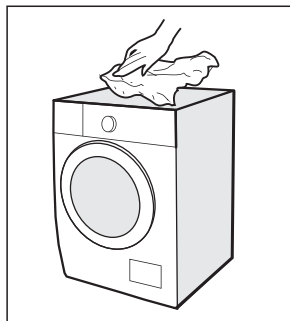

小心！

- 切勿使用研磨劑或腐蝕劑、甲酸 / 其稀釋溶劑或類似物質，如酒精或化學產品。

清潔滾筒

金屬物品在滾筒內留下的任何鏽跡必須立即使用無氯洗滌劑清除。切勿使用鋼絲球清潔滾筒！

注意！

- 清潔滾筒時，請將衣物遠離機器。

清洗門封和玻璃

每次洗滌完成後，請擦拭玻璃和門封，去除纖維和汙漬。如果纖維堆積，可能會導致漏水。每次洗滌完成後，取出門封中的硬幣、鈕扣和其他物品。機器每運行 60 次後（控制面板上會顯示 C2），請清潔門封及玻璃門，以確保設備正常運作。

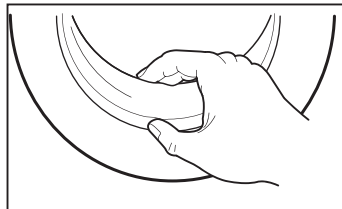

4 維護

清潔進水濾網



注意！

- 水流減少表明濾網需要清潔。

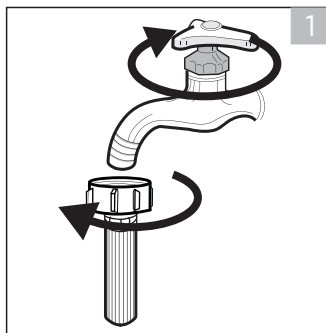

1. 關閉水龍頭，然後將供水管從水龍頭上卸下。

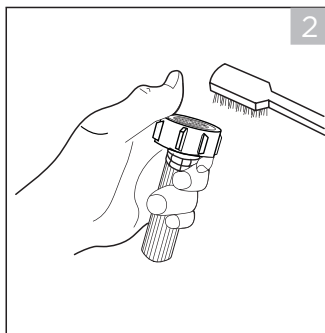

2. 用刷子清洗濾網。

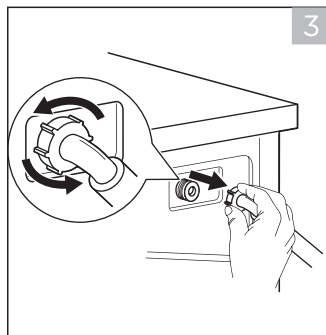

3. 從洗衣機背面將供水管旋轉擰下，取下軟管。用尖嘴鉗拔出濾網。

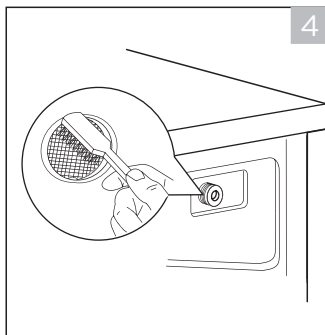

4. 用刷子刷洗濾網。

5. 將濾網重新裝回進水口，然後將供水管重新連接並擰緊。
6. 每當機器運行達 60 次（控制面板上會顯示 C2），請清潔進水濾網，以確保設備正常運作。

4 維護

清潔洗滌劑分配器

1. 按下柔順劑蓋上的釋放按鈕【】後，將洗滌劑分配器盒從槽內拉出。用刷子清潔凹槽內部。
2. 將柔順劑蓋從分配器盒上取下後，請以清水徹底清洗這兩個部件。
3. 請將柔順劑蓋裝回分配器盒，然後將分配器盒推回原來的凹槽內。

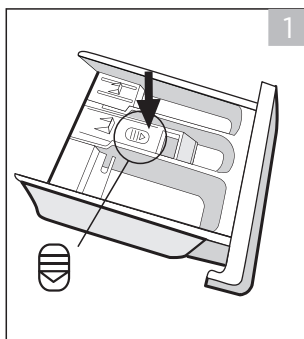

按下釋放按鈕，取下分配器盒

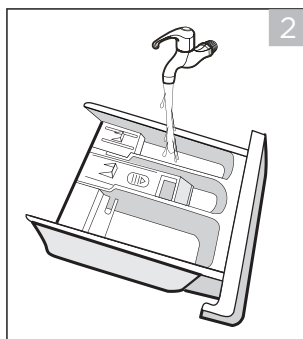

用水清洗分配器盒和柔順劑蓋

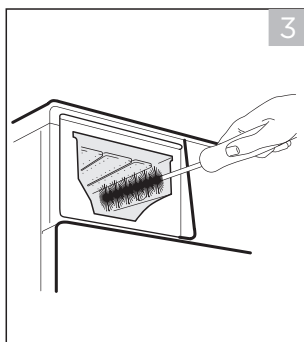

用軟刷清洗凹槽

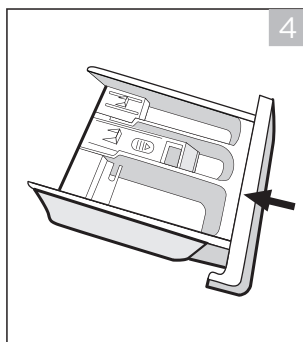

插入分配器盒

注意！

- 請勿使用磨損劑或腐蝕劑清潔塑膠零件。
- 機器每運行 60 次（控制面板上顯示 C2），請清潔洗滌劑分配器，以確保設備正常運作。

4 維護

清潔排水泵濾網

⚠ 警告！

- 確保洗衣機已經完成洗滌程式並排空。清潔排水泵濾網之前，請先關閉電源並拔掉插頭。
- 小心熱水。等待水冷卻下來。當心燙傷！
- 機器每運行 50 次（控制面板上顯示 C1），請定期清潔濾網，以確保設備正常運作。

1. 打開檢修板

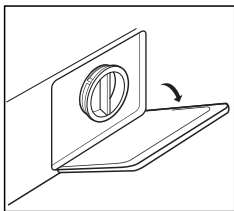

2. 逆時針旋轉打開濾網

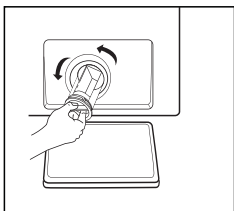

3. 清除雜物

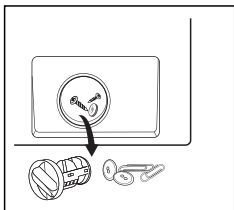

4. 裝回濾網及檢修板

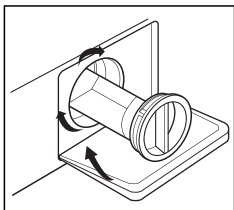

⚠ 小心！

- 設備在特定程式下運行時，排水泵內可能會有熱水。洗滌程式運行時，切勿拆卸泵蓋。先等待程式完成，然後取出洗衣機內衣物，再進行操作。更換蓋時，確保蓋已重新擰緊。

4 維護

■ 4.2 故障排除

每當洗衣機出現問題時，請進行檢查，確認您是否能夠按照下表解決問題。如果問題一直存在，請聯繫客服。

描述	可能原因	解決方案
設備無法啓動	門未關好。衣服被卡住。	關好門，重新啓動。 檢查衣物。
無法開門	安全保護被啓動。	斷開電源並重新啓動。
漏水	連接不夠緊固。	檢查並緊固供水管。檢查並清潔排水軟管。
洗滌劑分配器中殘留洗滌劑	洗滌劑受潮和 / 或凝結。	清洗並擦乾洗滌劑分配器。
指示燈或屏幕不亮	PC 板或線束存在連接問題。	關閉電源，檢查電源插頭是否連接正確。
異常噪音	運輸螺栓仍在原位。 地板不實或不平。	檢查是否已拆除運輸螺栓。確保設備安裝在堅實平整的地板上。

故障代碼

描述	可能原因	解決方案
E30	門未關好	關好門，重新啓動。
E10	清洗程式期間的注水問題。	檢查水壓是否足夠高。 拉直水管。清洗進水濾網。
E21	排水超時	檢查排水軟管是否堵塞。
E12	水溢出	重啓設備。
EXX	其他	重啓設備。如果問題一直存在， 請聯繫客服。

4 維護

■ 4.3 客戶服務

根據歐盟委員會第 2019/2023 號法規附件 II 中所列之生態設計要求，您所使用的洗衣機之備件，其供應有效期至少為 10 年。

如有疑問，請聯繫我們當地的客戶服務中心。



警告！

小心觸電！

- 切勿嘗試維修有缺陷或被認為有缺陷的設備。否則，可能危及自己和未來使用者的生命。只有經過授權的專業人員才能進行此項維修工作。
- 維修不當將使保修失效，後續損壞將不予認可！

5 技術規格

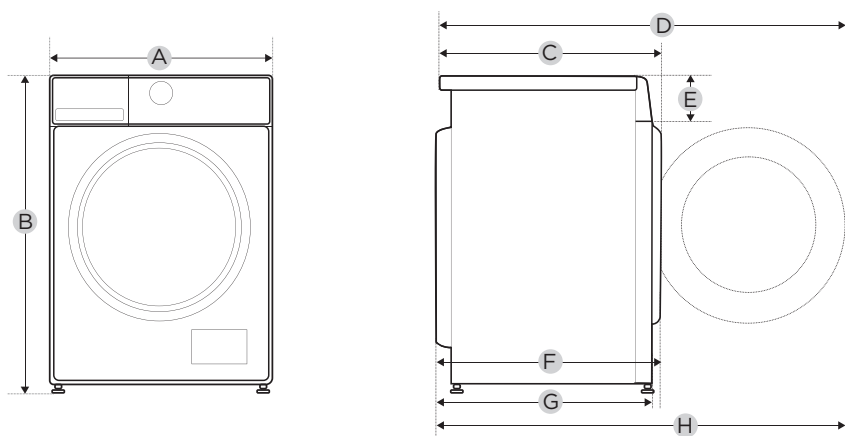

型號	TWD860
電源供應	220-240V~,50Hz
最大電流	10A
標準水壓	0.05 MPa-1 MPa
洗衣容量	8.0kg
乾衣容量	6.0kg
A	595mm
B	850mm
C(頂蓋至旋鈕)	510mm
參考尺寸	(僅供參考，請以實物為準。)
D	970mm
E	135mm
F	540mm
G	525mm
H	985mm
重量	63kg
額定功率	1900W
乾衣功率	1300W



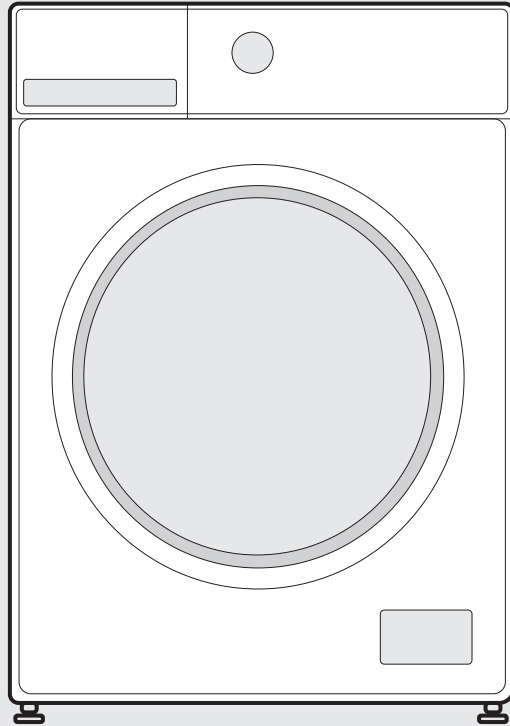

Washer Dryer

USER MANUAL

MODEL:TWD860

Warning notices: Before using this product, please read this manual carefully and keep it for future reference. The design and specifications are subject to change without prior notice for product improvement. Consult with your dealer or manufacturer for details. The diagram above is just for reference. Please take the appearance of the actual product as the standard.

Congratulations to your new machine !

This user manual will help you discover all the benefits of your machine and use it the way you want.



We strongly recommend that you read this manual carefully before using the washer dryer for the first time. It contains important safety instructions and information relating to the installation, operation and maintenance. Proper handling contributes to efficient, environmentally friendly and safe use and minimises energy consumption during operation. Please always keep the proof of purchase to preserve any warranty claims.

These instructions for use are in general terms. This means: Certain functions apply to your machine, while others do not. We are continuously working on the further development and improvement of our unit types and models. Therefore, we reserve the right to make changes to the design, features and accessories of all types and models without prior notice.

Explanation of symbols



Danger

This symbol indicates that there are dangers to the life and health of persons due to extremely flammable gas.



Warning of electrical voltage

This symbol indicates that there is a danger to life and health of persons due to voltage.



Warning

The signal word indicates a hazard with a medium level of risk which, if not avoided, may result in death or serious injury.



Caution

The signal word indicates a hazard with a low degree of risk which, if not avoided, may result in minor or moderate injury.



Notice:

The signal word indicates important information (e.g. damage to property), but not danger.



Observe instructions

Notes with this symbol indicate that you should read the operating instructions carefully.



Observe instructions

This symbol indicates that a service technician should only operate and maintain this appliance in accordance with the operating instructions.

CONTENTS

1 SAFETY INSTRUCTIONS	3	4 MAINTENANCE	30
1.1 Safety Instructions	3	4.1 Cleaning and Care	30
		Cleaning the Cabinet.....	30
2 INSTALLATION	11	Cleaning the Drum	30
2.1 Product Description	11	Cleaning the Door Seal and Glass..	30
Accessories	11	Cleaning the Inlet Filter	31
2.2 Installation	12	Cleaning the Detergent Dispenser	32
Installation area	12	Cleaning the Drain Pump Filter.....	33
Unpacking the machine.....	13	4.2 Trouble Shooting.....	34
Remove transport bolts	13	4.3 Customer Service.....	35
Levelling the machine.....	14		
Connect the water supply hose	14	5 TECHNICAL SPECIFICATION	36
Drain Hose	14		
Acoustic Sponge	15		
3 OPERATION	16		
3.1 Quick Start	16		
Calibration.....	16		
3.2 Before Each Washing	19		
3.3 Detergent Dispenser	20		
Detergent Recommendation	21		
3.4 Control Panel	22		
3.5 Display	23		
3.6 Programmes.....	24		
3.7 Option.....	26		

1 SAFETY INSTRUCTIONS

INTENDED USE

The product is intended only for home use and for textiles in household amounts suitable for washing and drying. This appliance is for indoor use only and not intended for built in use. Only use according to these instructions. The appliance is not intended for commercial use.

Any other use is considered as improper use. The producer is not responsible for any damage or injuries that may result of it.

- This appliance is intended to be used in household and similar applications such as:
 - Staff kitchen areas in shops, offices and other working environments;
 - Farm houses;
 - By clients in hotels, motels and other residential type environments;
 - Bed and breakfast type environments;
 - Areas for communal use in blocks of flats.

■ 1.1 Safety Instructions

Please read the following safety information thoroughly and follow it strictly to minimize the risk of fire or explosion, electric shock and to prevent property damage, personal injury or loss of life. Failing to follow these instructions shall void any warranty.



Warning!

This combination of symbol and signal word indicates a potentially dangerous situation which may result in death or serious injuries unless it's avoided.



Caution!

This combination of symbol and signal word indicates a potentially dangerous situation which may result in slight or minor injuries or damage to property and the environment.



Note!

This combination of symbol and signal word indicates a potentially dangerous situation which may result in slight or minor injuries.

1 SAFETY INSTRUCTIONS

Warning!

ELECTRIC SHOCK HAZARD

- If the supply cord is damaged, it must be replaced by the manufacturer, its service agent or similarly qualified persons in order to avoid a hazard.
- If the machine is damaged, it must not be operated unless repaired by the manufacturer, its service agent or similarly qualified persons.
- Risk of electric shock!
- The appliance can be used by children aged from 8 years and above and persons with reduced physical, sensory or mental capabilities or lack of experience and knowledge if they have been given supervision or instruction concerning use of the appliance in a safe way and understand the hazards involved. Children shall not play with the appliance. Cleaning and user maintenance shall not be made by children without supervision.
- Children should be supervised that they do not play with the appliance.
- Children of less than 3 years should be kept away unless continuously supervised.
- Animals and children may climb into the machine. Check the machine before every operation.
- Do not climb or sit on the appliance.

1 SAFETY INSTRUCTIONS

INSTALLATION LOCATION AND SURROUNDING

- All washing and additional substances are to be kept in a safe place out of the reach of children.
- Do not install the machine on a carpet floor.
- The obstruction of the openings by a carpet can damage the machine.
- Keep the appliance clear from heating sources and direct sunlight to avoid plastic and rubber parts to corrode.
- Do not use the appliance in humid environments or rooms containing explosive or caustic gas. In case of water leakage or water splashes let the appliance dry in the open air. The appliance must not be installed behind a lockable door, a sliding door or a door with a hinge on the opposite side to that of the washer dryer.
- Do not operate the machine in rooms with a temperature of below 5°C. This can cause damages to parts of it. If it is unavoidable, make sure to drain the water completely from the appliance after every use (see “Maintenance - Cleaning the drain pump filter”) to avoid damages caused by frost.
- Never use flammable sprays or substances in the immediate proximity of the appliance.

1 SAFETY INSTRUCTIONS

INSTALLATION

- Remove all packaging material and transport bolts before using the appliance. Otherwise, serious damage may result.
- This appliance is equipped with a single inlet valve and can be connected to the cold water supply only.
- Mains plug must be accessible after installation.
- Before washing clothes for the first time, the product shall be operated once throughout all the procedures without any clothes inside.
- Before using the washer dryer, the product shall be calibrated.
- Do not put any excessively heavy objects on the appliance, like water containers or heating devices.
- The new hose-sets supplied with the appliance are to be used and that old hose-sets should not be reused.
- Max. Inlet water pressure 1 MPa. Min. inlet water pressure 0.05 MPa.

ELECTRICAL CONNECTION

- Make sure the supply cable is not trapped by the machine, it can get damaged.
- Connect the product to a grounded outlet protected by a fuse complying with the values in the “Technical specifications” table. The grounding installation has to be made by a qualified electrician. Ensure that the machine is installed in accordance with the local

1 SAFETY INSTRUCTIONS

regulations.

- Water and electrical connections must be carried out by a qualified technician in accordance with the manufacturer's instructions and local safety regulations.

Warning!

- Don't use multiple plugs or extension cords.
- The appliance must not have an external switching device such as a timer or connected to a circuit that is regularly switched on and off.
- Do not pull the plug out of the mains outlet if there is flammable gas around.
- Never pull out power plug with wet hands.
- Always pull at the plug, not at the cable.
- Always unplug the appliance if it is not being used.

WATER CONNECTIONS

- Check the connections of the water supply hose, the water tap and the drain hose for possible problems due to changes of water pressure. If the connections loosen or leak, close the water tap and get it repaired.
- Do not use the appliance before the pipes and hoses are installed properly by qualified persons.
- Glass door may become very hot during the operation. Keep children and pets far away from the machine while it is operating. The water supply and drain hoses have to be safely installed and remain undamaged.
- Otherwise, water leakage can occur.

1 SAFETY INSTRUCTIONS

- Do not remove the drain pump filter while there is still water in the appliance. Big quantities of water can leak out, and there is a risk of scalding due to hot water.

OPERATION AND MAINTENANCE



Warning!

- Never stop the washer dryer before the end of the drying programme unless all items are quickly removed and spread out so that the heat can dissipate.
 - The washer dryer is not to be used if industrial chemicals have been used for cleaning. Risk of explosion.
-
- Never use any flammable, explosive or toxic solvents. Do not use gasoline and alcohol etc. as detergents. Only select detergents that are suitable for machine washing.
 - Make sure that all pockets are emptied. Sharp and rigid items such as coins, brooches, nails, screws, stones etc. may cause serious damages to this machine.
 - Remove all objects from pockets such as lighters and matches before use the appliance. Thoroughly rinse items that have been washed by hand.
 - Do not dry unwashed items in the appliance. Items that have been soiled with substances such as cooking oil, acetone, alcohol, petrol, kerosene, spot removers, turpentine, wax and wax removers should be washed in hot with an extra amount of detergent before being dried in the appliance.
 - Items containing foam rubber (latex foam), shower caps, water proof textiles, rubber

1 SAFETY INSTRUCTIONS

backed articles and clothes or pillows fitted with foam rubber pads should not be dried in the machine.

- Fabric softeners or similar products should be used as recommended in their instructions.
- Never try to open the door forcefully.
- The door will unlock shortly after the end of a programme.
- Please do not close the door with excessive force. If it is found difficult to close the door, please check if the clothes are properly inserted and distributed.
- Always unplug the appliance and close the water tap before cleaning and maintenance and after each use.
- Never pour water over the appliance for cleaning purpose. Risk of electric shock!
- Repairs shall only be carried out by the manufacturer, its service agent or similarly qualified persons in order to avoid a hazard.
- The producer will not be responsible for damages caused by the intervention of not authorized persons.

TRANSPORT

IMPORTANT STEPS WHEN MOVING THE APPLIANCE

- Unplug the appliance and close the water inlet tap.
- Check, if the door and the detergent dispenser are closed properly.
- Remove the water supply and drain hoses from the house installations.
- Let the water drain completely from the

1 SAFETY INSTRUCTIONS

appliance (see “Maintenance - Cleaning the drain pump filter”).

- Important: Re-install the 4 transport bolts in the back of the appliance.
- This appliance is heavy. Transport with care. Never hold any protruding part of the machine when lifting. The machine door can not be used as a handle. Unplug the appliance and close the water inlet tap.

ENVIRONMENT

Disposal of old appliances

(Only for EU countries)

This appliance is labelled in accordance with the European Directive 2012/19/EU on waste electrical and electronic equipment (WEEE). The directive provides the framework for the EU-wide take-back and recycling of waste equipment.



**The devices marked with this symbol
must not be disposed of in household waste !**

As a manufacturer, we ensure environmentally friendly treatment and recycling of old appliances within the scope of product responsibility. Our products are registered with the authorities for electrical appliances and packaging. For further information on collection and disposal, please contact your local authority, city council or your

(specialised) retailer. Already during the development of new appliances, we pay attention to a high recyclability of the materials used. High recycling rates are achieved via the take-back system to reduce the burden on waste dumps and the environment. Together, we are making an important contribution to environmental protection.

Model	Washing/Drying Capacity
TWD860	8.0/6.0kg

2 INSTALLATION

2.1 Product Description

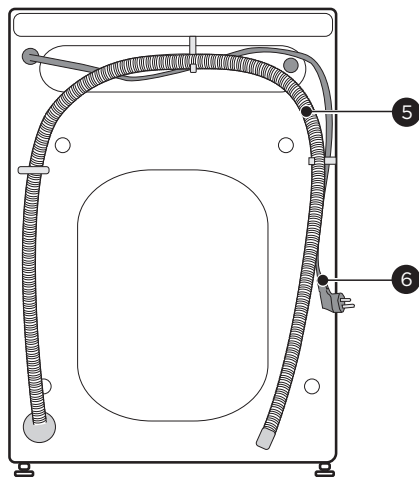
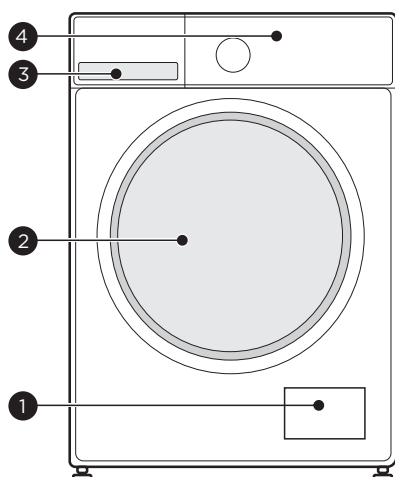

1 Service flap

2 Door

3 Detergent dispenser

4 Control panel

5 Drain hose

6 Power supply cord



Note!

- The product picture is for illustration only, please refer to real product as reference.

Accessories

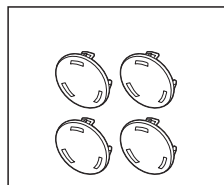

4 x Cover
caps

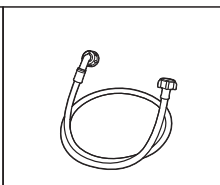

1 x Supply hose
cold water

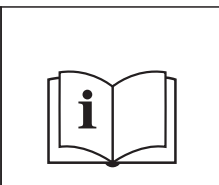

1 x Owner's
manual



Acoustic sponge
(optional)

2 INSTALLATION

2.2 Installation

Tools Needed If Installation By Yourself (not include)

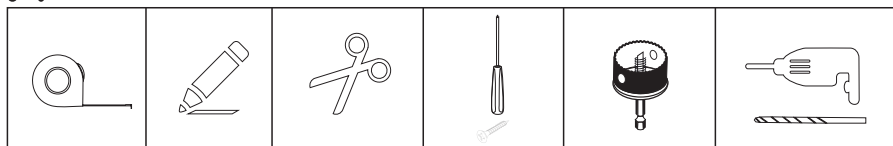

Installation area

Warning!

- Stability is important to prevent the product from wandering!
- Make sure the machine is standing leveled and stable.
- Make sure that the product does not stand onto the power cord.
- Suggest to maintain the minimum distances from the walls as shown in the picture

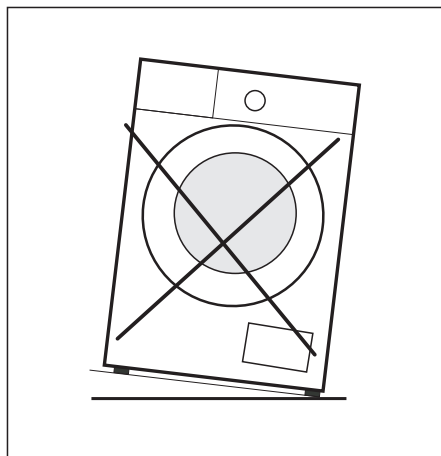
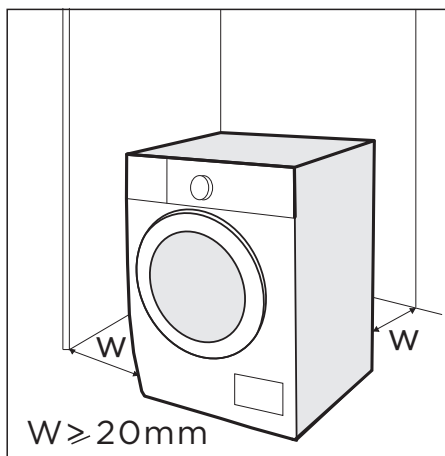

Before installing the machine, the location characterized as follows shall be selected:

1. Rigid, dry, and level surface
2. Avoid direct sunlight
3. Sufficient ventilation
4. Room temperature is above 5°C
5. Keep far away from the heat sources such as coal or gas burning appliances.

2 INSTALLATION

Unpacking the machine

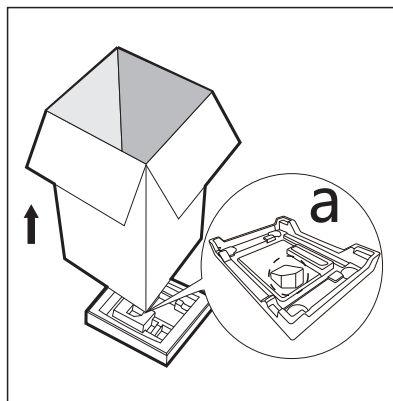

Warning!

- Packaging material (e.g. Films, Styrofoam) can be dangerous for children.
- There is a risk of suffocation ! Keep all packaging well away from children.

1. Remove the cardboard box and styrofoam packing.
2. Lift the washer dryer and remove the base packaging. Make sure the small triangle foam (a) is removed with the bottom packaging together.
If not, lay the unit down on the side surface and remove it manually.
3. Remove the tape securing the power supply cord and drain hose.
4. Remove the supply hose from the drum.

Remove transport bolts

Warning!

- You must remove the transport bolts from the backside before using the product.

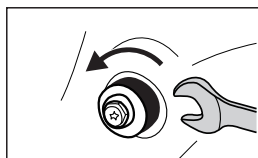

Loosen the 4 transport bolts with a spanner.

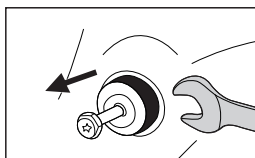

Remove the bolts including the rubber parts and keep them for future use.

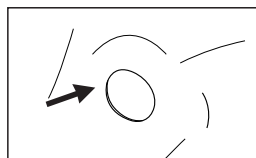

Close the holes using the cover caps.

2 INSTALLATION

Levelling the machine

Warning!

- The lock nuts on all four feet must be screwed tightly against the housing.

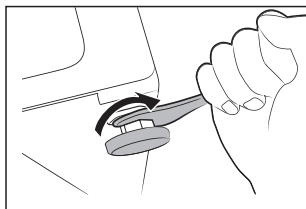

1. Loosen the lock nut.
2. Turn the foot until it reaches the floor.
3. Adjust the legs and lock the nuts with a spanner. Make sure the machine is level using a spirit level.

Connect the water supply hose

Warning!

To prevent leakage or water damage, follow the instructions in this chapter.

- Do not kink, crush or modify water supply hose.

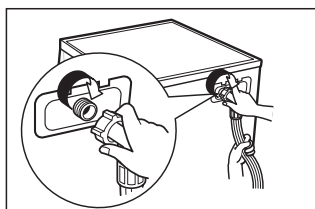

Connect the water supply hose to the water inlet valve and a water tap with cold water as indicated.

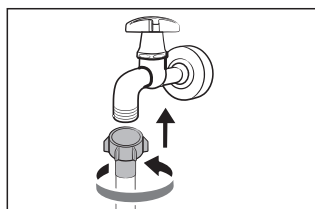

Note!

- Connect manually, do not use tools. Check if the connections are tight.

Drain Hose

Warning!

- Do not kink or protract the drain hose.
- Position drain hose properly ,otherwise damage might result of water leakage.
- It is not allowed to remove the buckle of drain hose.

2 INSTALLATION

There are two ways to place the end of drain hose:

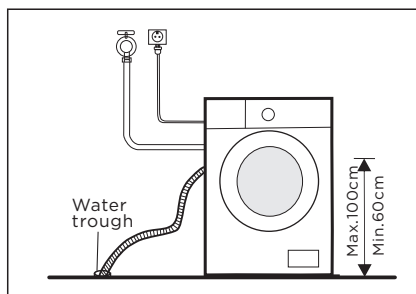

1. Put it into the water trough.

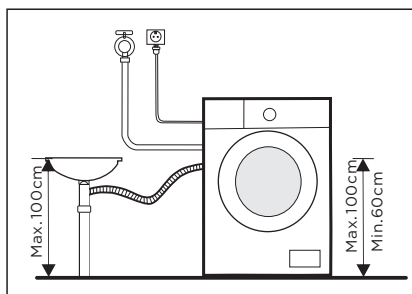

2. Connect it to the branch drain pipe of the trough.

Note!

- The image is for illustrating the height requirements in installation only.

Acoustic Sponge(Optional)

Note!

- Acoustic sponge is an optional accessory, installed upon customer request and subject to an additional installation fee. It can effectively reduce the noise caused by the machine while working, in order to provide you with a more peaceful and quiet living environment.

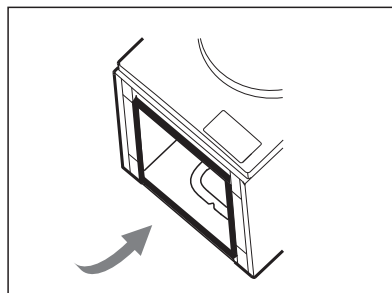
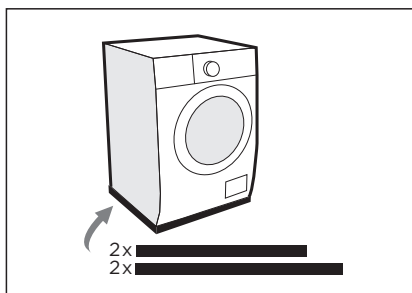

1. Get the machine laid on the floor, using some soft material like foam or clothes between the machine and floor for a protection;
2. Stick the 2x longer sponges to the longer bottom edges of machine, and the 2x shorter sponges to the shorter bottom edges.

3 OPERATION

■ 3.1 Quick Start

Caution!

- Before washing, please make sure the washer dryer is installed properly.
- Your appliance was thoroughly checked before it left the factory. To remove any residual water and to neutralize potential odors, it's recommended to clean your appliance before first use. For this reason, For this reason, recommended to clean the inner drum by running the "Drum Clean" or other programme with the optional temperature of 90°C. Be careful not to put laundry and detergent in the machine.

Calibration

It's recommended to calibrate the washer dryer, so that provide the best performance.

The appliance is able to detect the amount of laundry loaded. This function is optimizing the product performance by minimizing energy and water consumption, saving you money and time. For this reason it's recommended to calibrate the appliance for best use.

1. Remove all accessories from the drum and close the door;
2. Insert the main plug to the socket;
3. Switch on the washer dryer and press "Funct." and "Dry" simultaneously for 10 seconds until "t19" is displayed;

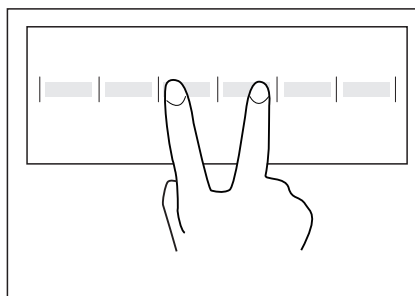

4. Press [▷||] to start the appliance and wait till "*****" is displayed. If the machine is successfully calibrated, "PAS" will be displayed, otherwise, "FAL" will be displayed.

3 OPERATION

1. Before Washing

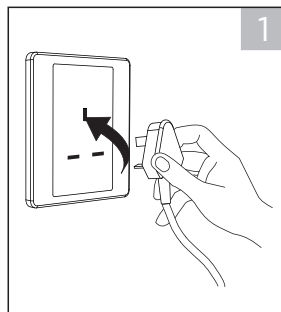

Plug in

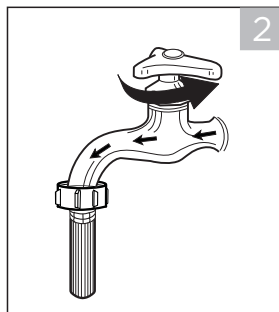

Open tap

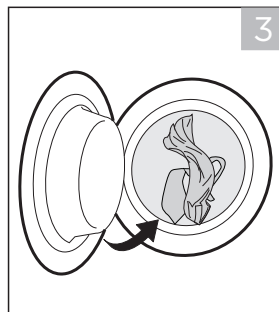

Load

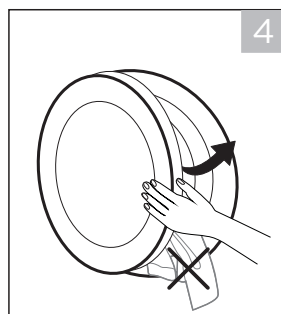

Close door

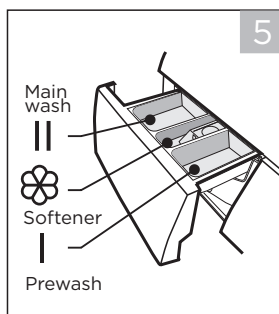

Add detergent

Note!

- Detergent need to be added in compartment I if the pre-wash function is selected.
- Do not put laundry beads into the detergent dispenser.
- When closing the door, please make sure that your clothes are not caught between the sealing ring and the machine door to prevent water leakage caused by pulling and damaging the sealing ring during operation.

3 OPERATION

2. Washing

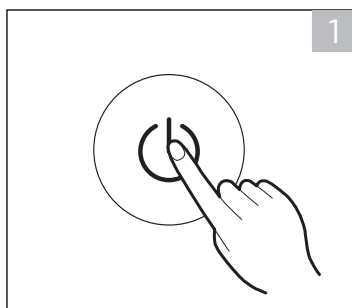

Power on

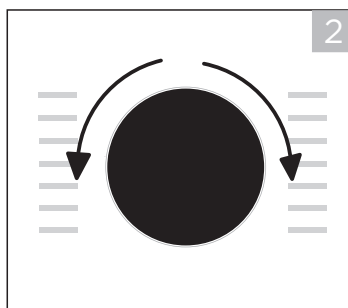

Select programme

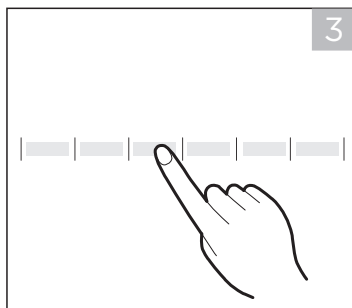

Select function or remain default settings

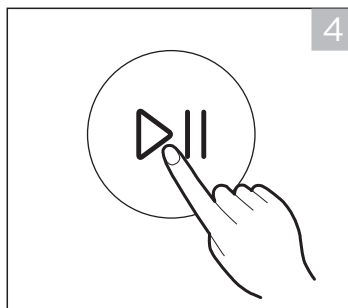

Press Start/Pause to start the programme

Note!

- 1 : If default is selected, step 3 can be skipped.
- 2: The function button line chart is for reference only, please refer to real product as standard.

3 OPERATION

■ 3.2 Before Each Washing

- The ambient temperature of the washer dryer should be 5°C-40°C. If used under 0°C, the inlet valve and draining system may be damaged. If the machine is installed under freezing conditions, it should be transferred to normal ambient temperature to ensure the water supply hose and drain hose can unfreeze before use.
- Please check your laundry care labels and the detergent use instructions before wash. Use non-foaming or less-foaming detergent suitable for machine properly.

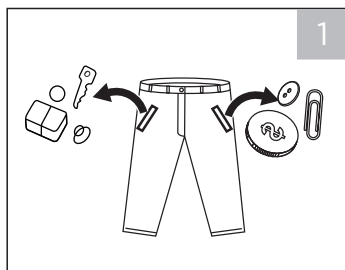

Take all items out of the pockets

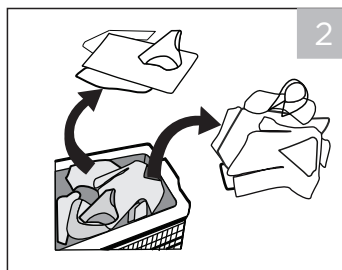

Sort laundry according to color and textile type

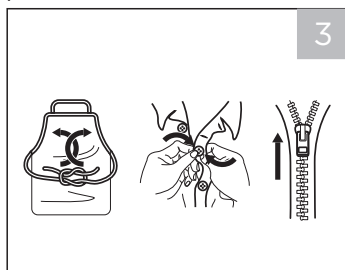

Tie together long textile strips and belts, close zips and button

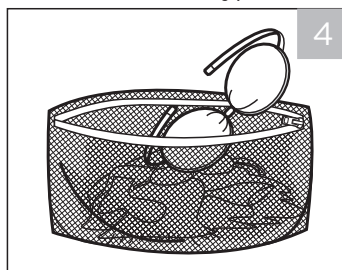

Put small items into a laundry bag

Warning!

- Do not wash or dry articles that have been cleaned in, washed in, soaked in, or dabbed with combustible or explosive substances like wax, oil, paint, gasoline, alcohol, kerosene, and other flammable materials.
- Washing single clothes items may easily create big eccentricity . Therefore it is suggested to add one or two more laundry items to the wash so that spin can be done smoothly.
- Do not wash, spin, or dry water-proof seats, mats, or clothing.

3 OPERATION

■ 3.3 Detergent Dispenser

- I Pre wash
- II Main wash
- ☼ Softener
- ☼ Release button to pull out the dispenser

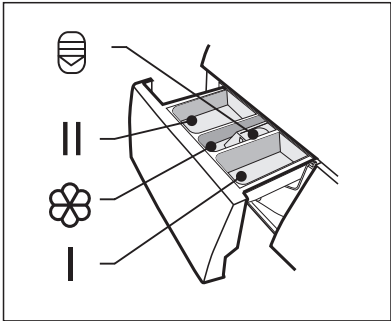

⚠ Caution!

- Detergent only need to be added in “compartment I ”after selecting pre-wash function.
- Do not put laundry beads into the detergent dispenser.

Programme	I	II / ☼	☼	Programme	I	II / ☼	☼
Cotton	○	●	○	Rinse&Spin			○
Mix	○	●	○	Wool		●	○
Baby Care	○	●	○	ECO 40-60		●	○
20°C		●	○	Intensive	○	●	○
Drum Clean				Quick 15'/1h WD		●	○
Spin Only				Dry Only			
Wash and Dry		●	○				

● Means must ○ Means optional

3 OPERATION

Detergent Recommendation

Recommended washing detergent	Type of laundry and textile	Wash programmes	Washing temp. °C
Heavy-duty detergent with bleaching agents and optical brighteners	White laundry made from boil-proof cotton or linen	Cotton, Mix, Intensive	40/60 /90
Colour detergent without bleaching agent and optical brighteners	Coloured laundry made from cotton or linen	Cotton, ECO 40-60, Mix, Intensive	Cold/20/30/40
Color or mild detergent without optical brighteners	Coloured laundry made from easy care fibres or synthetic materials	20°C	Cold/20
Mild washing detergent	Delicate textiles, silk, viscose	Wool	20 /30
Special wool detergent	Wool	Wool	20/30 /40



Note!

- Agglomerating or ropy detergent or additive can be diluted in some water before pouring it into the detergent dispenser, to avoid its inlet to get blocked and thus cause a water overflow.
- Please choose the suitable type of detergent to get a maximum of washing performance and a minimum of water and energy consumption.
- To achieve the best cleaning result a proper detergent dosing is important.
- Use a reduced detergent amount if the drum is not filled completely.
- Always adjust the amount of detergent to the water hardness, if your tap water is soft, use less detergent.
- Dose according to how dirty your laundry is, less dirty clothes require less detergent.
- Highly concentrated (compact detergent) requires particularly accurate dosing.

Following symptoms are a sign of detergent overdosing:

- heavy foam formation
- poor washing and rinsing result

Following symptoms are a sign of detergent underdosing:

- laundry turns grey
- built-up of limescale deposits on the drum, the heating element and/or the laundry

3 OPERATION

■ 3.4 Control Panel

Model: TWD860

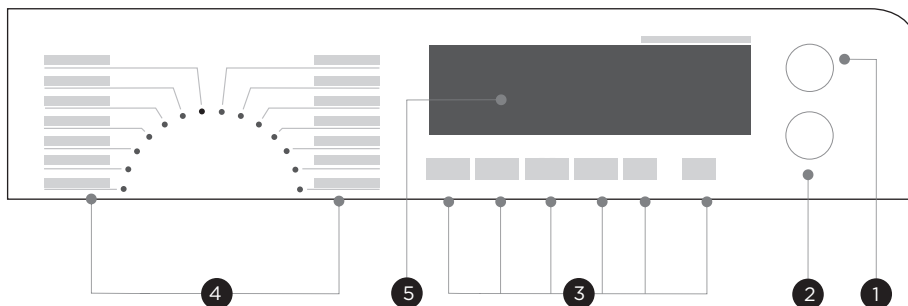

1 On/Off

Turn the appliance on and off.

2 Start/Pause

Start or pause your programme.

3 Option

This allows you to select additional functions and will light when selected.

4 Programmes

Available according to the laundry type.

5 Display

The display shows settings, estimated remaining time, options and status messages.

3 OPERATION

■ 3.5 Display

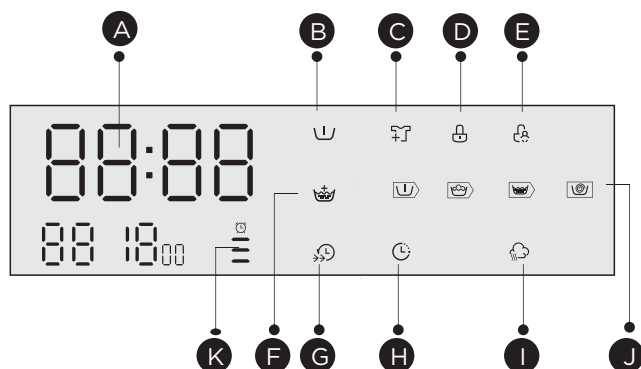

A Display

Wash Time
1:25
Speed
400
End
End

Delay Time
2H
Error
E30
Temp.
30

B Pre Wash

C Reload

D Door Lock

E Child Lock

F Extra Rinse

G Speed Wash

H Delay

I SpaCare

J Pre Wash-Wash-Rinse-Spin

K Dry

3 OPERATION

■ 3.6 Programmes

Programmes are available according to the laundry type.

Programmes	
Cotton	Hard-wearing textiles, heat-resistant textiles made of cotton or linen.
Baby Care	Washing the baby's clothes, it can make the baby's wear cleaner and make the rinse performance better to protect the baby skin.
Mix	Mixed load consisting of textiles made of cotton and synthetics.
20°C	Able to clean lightly soiled cotton laundry, at a nominal temperature of 20 °C.
ECO 40-60	Able to clean normally soiled cotton laundry declared to be washable at 40 °C or 60 °C, together in the same cycle.
Quick 15'	Extra short programme, suitable for lightly soiled washing as a small amounts of laundry.
1h W/D	Suitable for small synthetic clothes or shirts, load limitation is 1 kg (about 4 shirts).
Wool	Hand or machine-washable wool or richwool textiles. Especially gentle wash programme to prevent shrinkage, longer programme pauses (textiles rest in wash liquor).
Spin Only	Spins and drains the water.
Rinse&Spin	Rinses and then spins the laundry, and then drains the water.
Intensive	To increase the washing effects, washing time is increased. Specially set in this machine to clean the drum and tube. It applies 90 °C high temperature sterilization to make the clothes washing more green.
Drum Clean	When this programme is performed, the clothes or other washing cannot be added. The customer can use this programme regularly according to the need, recommended to use every month for frequent user.
Dry Only	Select it to dry clothes, the temperature is different . The drying time according to the load .
Wash and Dry	The standard energy programme for washing and drying.

Note!

- Reference to your product to select the programmes.

3 OPERATION

Model:TWD860

	Programme	Washing /Drying Load(kg)	Display Time
	8.0		
☀	Cotton	8.0/6.0	3:00
☀	Mix	8.0/6.0	1:30
☀	Wash and Dry	6.0/6.0	5:16
☀	Dry Only	--/6.0	4:09
	20°C	4.0/--	1:01
☀	Baby Care	4.0/4.0	2:01
	Drum Clean	--	1:18
	Spin Only	8.0/--	0:12
	Rinse&Spin	8.0/--	0:20
	Wool	2.0/--	1:07
	ECO 40-60	8.0/--	3:38
	Intensive	8.0/--	1:28
	Quick 15'	2.0/--	0:15
☀	1h WD	1.0/1.0	0:58

- The HK Energy Efficiency class is: I .
Energy test program: Cotton, Temp.:60°C; Speed: 1200, Other as the default.

3 OPERATION

3.7 Option

Programme	Default Temp.(°C)	Default spin speed (rpm)	Additional functions
		1400	
Cotton	40	1400	🕒, 📏, 👑, 🔄, 🌞
Mix	40	1400	🕒, 📏, 👑, 🔄, 🌞
Wash and Dry	40	1400	🕒, 🌞
Dry Only	-	1200	🕒, 🌞
20°C	20	1000	🕒, 👑, 🔄
Baby Care	60	1000	🕒, 📏, 👑, 🔄, 🌞
Drum Clean	90	400	🕒
Spin Only	Cold	1000	🕒
Rinse&Spin	Cold	1000	🕒, 👑
Wool	40	600	🕒, 👑
ECO 40-60	60	1400	🕒
Intensive	40	1000	🕒, 📏, 👑, 🔄, 🌞
Quick 15'	Cold	800	🕒, 👑
1h WD	Cold	1400	🕒, 🌞, 👑

Note!

- For the maximum spin speed, programme time, and other details of the ECO 40-60 and Wash and Dry programme, please refer to the content on the Operation – Programmes.
- The table shows which programme offers which options for adjustment

3 OPERATION



Delay

Set the Delay function:

1. Select a programme;
2. Press the Delay button to choose the time (the delaying time is 0-24 H.);
3. Press [Start/Pause] to commence the delay operation



Choose the Programme Setting time Start

Cancel the Delay function:

Press the [Delay] button until the display be OH. It should be pressed before starting the programme. If the programme already started, should switch off programme to reset a new one.



Pre Wash

The Prewash function can get an extra wash before main wash, it is suitable for washing the dust rises to surface of the clothes; You need to put detergent into the compartment when select it.



Extra Rinse

The laundry will undergo extra rinse once after you select it.



Speed Wash

The function can decrease the washing time.



My Cycle

To memory the frequently used programme.

After choosing the programme and setting the options, press [Temp.] 3 sec. before start to wash. The default setting course is Cotton.



Temp.

Press the button to regulate the temperature (Cold, 20°C, 30°C, 40°C, 60°C, 90°C)



Speed

Press the button to change the speed.

1400: 0-400-600-800-1000-1200-1400



SpaCare

SpaCare function can be selected by choose "Cotton", "Mix", "Intensive" and "Baby Care".



Note!

- When using this function in combination with other functions, "SpaCare" need to be selected last.

3 OPERATION



Reload

This operation can be executed during the washing progress. When the drum is still rolling and there is large amount of water with high temperature in the drum.

The state is unsafe and the door can not be opened forcefully. To press [Start/Pause] for 3 sec. to reload, and start the clothes adding in the midway function. Please follow the steps as bellow:

- 1.Wait until the drum stops rotation.
- 2.The door lock is unlocked.
- 3.Close the door when the clothes are reloaded and press the [Start/Pause] button.



Press[Start/Pause]3sec.

Reload the clothes

Start



Caution!

- Don't use the Reload function when the water level over the edge of the inner tub or the temperature is higher.



Dry

Press the Dry button continuously to choose the dry level: Extra Dry/Normal Dry(Normal)/ Gentle Dry(Soft).

- ≡ Extra Dry:Need to wear clothes immediately ,we can choose this function;
- = Normal Dry(Normal): The normal dry procedure;
- Gentle Dry(Soft):Only to dry slightly and then is just ok;
- 🕒 Timed Dry:We can choose this function to dry clothes for a specific time(30/60/90/120/180 minutes).



Note!

- Drying hints
 - Thoroughly spin you laundry before drying.
 - To ensure proper drying, please sort your laundry according to the fabric type and drying temperature.
- Clothes not suitable for drying
 - Particularly delicate items such as synthetic curtains,woolen and silk, clothes with metal inserts,nylon stockings,bulky clothes,such as anoraks,bedcovers,quilts,sleeping bags and duvets must not be dried.
 - Clothes padded with foam-rubber or materials similar to foam-rubber must not be machine dried.
 - Fabrics containing residues of setting lotions or hair sprays, nail solvents or similar solutions must not be machine dried in order to avoid the formation of harmful vapours.

3 OPERATION



Child Lock

To avoid mis operation by children.



Press [Delay] and [SpaCare]
3 sec. till buzzer beep.



Caution!

When child lock is activated and programme starts, child lock indicator will switch on, "CL" and remaining time on the display are alternately displayed.

Press the other buttons will make child lock indicator flash. when programme finish, "CL" and "End" alternate on the display.

- Only press and hold the two button can release child lock, even power off, switch off and program end.
- The "Child Lock" will lock all buttons except Power button and Child Lock button.
- Please release child lock before selecting program and starting washing.



Mute the buzzer



Choose the Programme Press the [Speed] button for 3sec., the buzzer is mute.

To act the buzzer function, press the button again for 3 seconds. The setting will be kept until the next reset.



Caution!

- After Muting the buzzer function, the sounds will not be activated any more.



Note!

Usage counter

1: Please press "Temp." and "SpaCare" on control panel simultaneously and continuously for around 5sec. under power-on status, the device display shows digits--the value can indicate the times of equipment usage.

2: Press press "Temp." and "SpaCare" on control panel simultaneously and continuously for around 5sec. and customer can resume to normal operation.

4 MAINTENANCE

■ 4.1 Cleaning and Care

Warning!

- Always unplug the appliance and close the water tap before cleaning and maintenance.

Cleaning the Cabinet

Proper maintenance on the washer dryer can extend its working life. The surface can be cleaned with diluted non-abrasive neutral detergents when necessary. If there is any water overflow, use a towel to wipe it off immediately.
Never use sharp items to clean the appliance.

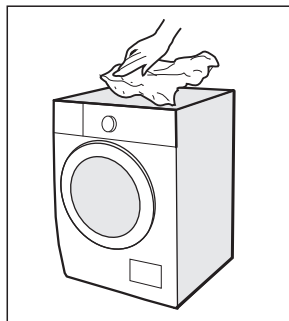

Caution!

- Never use abrasive or caustic agents, formic acids or its diluted solvents or similar substances, like alcohol or chemical products.

Cleaning the Drum

Any rust stains left inside the drum by metal articles must be removed immediately using chlorine-free detergents. Never use steel wool for cleaning the drum!

Note!

- Keep any laundry away from the machine while cleaning the drum.

Cleaning the Door Seal and Glass

Wipe the glass and seal after each wash to remove lint and stains. If lint builds up it can cause leakages.

Remove any coins, buttons and other objects from the seal after each wash. Clean the Door Seal and Glass every the machine runs 60 times (appear C2 on control panel) to ensure the normal operation of the appliance.

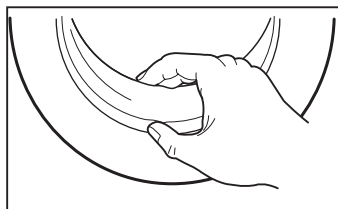

4 MAINTENANCE

Cleaning the Inlet Filter



Note!

- Diminishing water flow is a sign that the filter need to be cleaned.

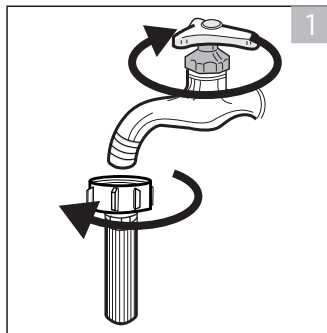

1. Close the tap and remove the water supply hose from it.

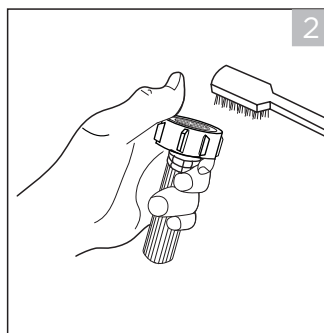

2. Clean the filter with a brush.

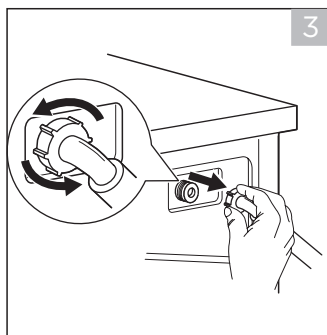

3. Unscrew the water supply hose from the backside of the machine. Pull out the filter with long nose pliers.

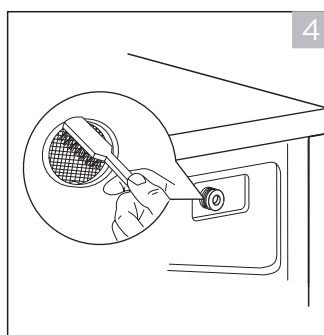

4. Use a brush to clean the filter.

5. Reinstall the filter to the water inlet and reconnect the water supply hose.
6. Clean the Inlet filter every the machine runs 60 times (appear C2 on control panel) to ensure the normal operation of the appliance.

4 MAINTENANCE

Cleaning the Detergent Dispenser

1. Press down the release [] on the softener cover and pull the dispenser drawer out of the recess. Clean the inside of the recess with a brush.
2. Lift the softener cover off the dispenser drawer and wash both items with water.
3. Restore the softener cover and push the drawer back into the recess.

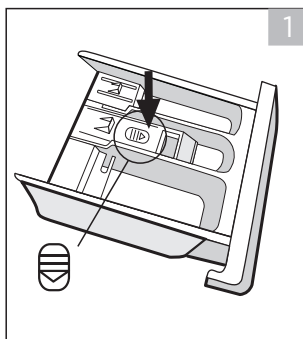

Press the release and remove the dispenser drawer

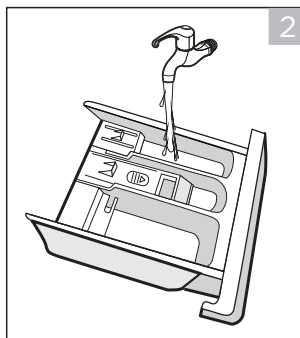

Clean the dispenser drawer and the softener cover under water

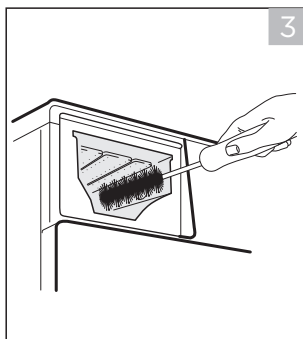

Clean the recess with a soft brush

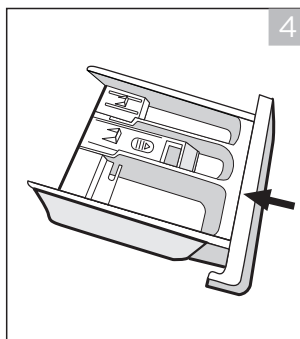

Insert the dispenser drawer

Note!

- Do not use abrasive or caustic agents to clean plastic parts.
- Clean the detergent dispenser every the machine runs 60 times (appear C2 on control panel) to ensure the normal operation of the appliance.

4 MAINTENANCE

Cleaning the Drain Pump Filter

Warning!

- Make sure that the machine has finished the washing programme and is empty. Switch it off and unplug it before cleaning the drain pump filter.
- Be careful of hot water. Wait for water cooling down. Risk of scalding!
- Clean the filter periodically every the machine runs 50 times (appear C1 on control panel) to ensure the normal operation of the appliance.

1.Open the service flap

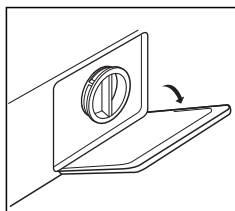

2.Open the filter by turning to the counter clockwise

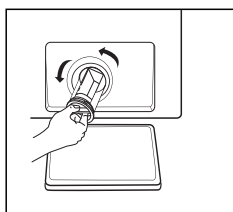

3.Remove extraneous matter

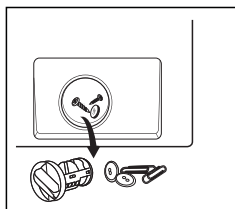

4.Close the filter and the service flap

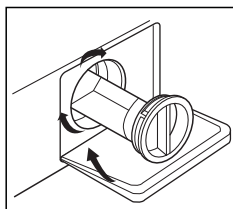

Caution!

- When the appliance is in use and depending on the programme selected there can be hot water in the pump. Never remove the pump cover during a wash programme, always wait until the appliance has finished the programme, and is empty. When replacing the cover, ensure it is securely re-tightened.

4 MAINTENANCE

■ 4.2 Trouble Shooting

Whenever there is a problem with the appliance, check if you can solve it following the tables below. If the problem persists, please contact the customer service.

Description	Possible cause	Solution
Appliance does not start	Door is not closed properly.Clothes are stuck.	Close the door properly and restart. Check the laundry.
Door can't be opened	Safety protection is activated.	Disconnect the power and restart.
Water leakage	Connections are not tight enough.	Check and fasten the water supply hose.Check and clean the drain hose.
Detergent residues in the detergent dispenser	Detergent is damp and/or clotted.	Clean and wipe the detergent dispenser dry.
Indicator or display does not work	PC board or harness have connection problems.	Switch off the power and check if the mains plug is connected properly.
Abnormal noise	Fixing bolts still in place. Floor is not solid or level.	Check if the transport bolts have been removed. Make sure the appliance is installed on a solid and level floor.

Error Codes

Description	Possible cause	Solution
E30	Door is not closed properly.	Close the door properly and restart.
E10	Water injecting problem during wash programme.	Check if the water pressure is high enough. Straighten the water pipe. Clean the inlet valve filter.
E21	Overtime water draining	Check the drain hose for blockage.
E12	Water overflow	Restart the appliance.
EXX	Others	Restart the appliance. If problem persists, please contact the customer service.

4 MAINTENANCE

■ 4.3 Customer Service

Spare part for your appliance are available for a minimum of 10 years following EU COMMISSION REGULATION 2019/2023 ANNEX II Ecodesign requirements.

In case of questions, please contact our local customer service center.



Warning!

Risk of electric shock

- Never try repair an appliance which is defective or presumed to be defective. You may put your own and future users' lives in danger. Only authorised specialists are allowed to carry out this repair work.
- Improper repair will void the warranty and subsequent damages can't be recognized!

5 TECHNICAL SPECIFICATION

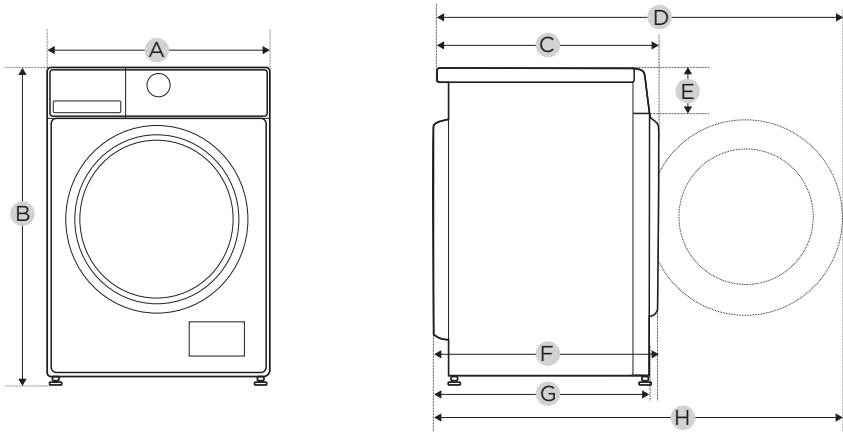

Model	TWD860
Power Supply	220-240V~,50Hz
MAX.Current	10A
Standard Water Pressure	0.05MPa-1MPa
Washing Capacity	8.0kg
Dry Capacity	6.0kg
A	595mm
B	850mm
C(top cover to knob)	510mm
Reference Dimension	(for reference only, please refer to the real product.)
D	970mm
E	135mm
F	540mm
G	525mm
H	985mm
Weight	63kg
Rated Power	1900W
Drying power	1300W

