

# 二合一手提蒸氣熨斗掛燙機

## 使用說明書

型號：TGS150

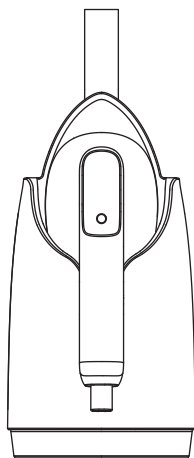

- 使用前請仔細閱讀本說明書並妥善保存。
- 說明書中的圖片僅供參考用，請以實物為準。
- 如產品有任何變更，請參看最新版本的說明書。

# 歡迎使用

感謝您選購我們的產品。為確保您能正確、安全地使用本產品，敬請於使用前詳閱本說明書內容。同時，請妥善保存購買憑證，以便日後查詢或申請售後服務之用。

## 目錄

一、	安全及注意事項	1
二、	產品參數	2
三、	電路原理圖	2
四、	產品結構部件	3
五、	使用說明	4
六、	清潔保養	7
七、	常見問題及維護	8

# 安全及注意事項

使用之前，請全面地閱讀使用說明書，並在操作時嚴格遵守。請新的使用者瞭解下列注意事項：

1. 請使用正確供電電壓：220-240V~ 50-60Hz，連接不正確的電壓可能損壞本機。
2. 請勿在規定範圍外使用本產品。
3. 不要與大功率電器共用一個供電插座使用。
4. 本產品使用時切勿讓兒童、心智或殘障人士靠近及使用。
5. 產品不得用於兒童玩耍。
6. 當產品處於通電狀態及發熱狀態時，請小心看管。請勿閒置本產品。
7. 當產品跌落，或者電源線、插頭、蒸氣管線有可見的損壞跡象而不能使用，為了確保使用者的安全，切勿擅自更換，務必委託本公司的維修點或具資格的人員來更換。
8. 使用本產品前必須先往水箱裡注滿水，使用過程中請注意觀察水箱中的水量變化，及時往水箱中加水。
9. 請不要在水箱中加入 40°C 或以上熱水或任何清水以外的液體。
10. 請不要直接對人、動物或穿在身體上的衣服進行熨燙。
11. 使用本產品時，切勿接觸燙頭底板、蒸氣，以免燙傷。
12. 使用本產品時，電源線遠離發熱表面，不允許電源線碰到發熱表面。
13. 使用本產品時，電源線不要接觸到尖銳物體，防止電源線損傷。如要把電源線拔離插座，必須用手握電源線插頭將其拔出，切勿用拉電源線方法拔插頭。
14. 在使用完本產品時，請按正確方法拔出電源插頭。
15. 請確保本機器遠離易燃物品及化學物品。
16. 請勿將熨斗頭浸入水中。
17. 為防止漏電及其它危險，不使用及進行清潔前須關掉本機。

警告：

1. 如果電源線損壞，為了避免危險，必須由製造商、其維修部或專業人員更換；若保險絲、電路板、發熱系統等部件損壞或不能正常工作，同樣需要專業人員更換。
2. 在電熨斗接通電源期間，使用者不得離開。
3. 在為水箱注水前必須將本產品電源線的插頭從插座上拔掉。
4. 電熨斗必須在穩定的表面上使用和放置。
5. 當把電熨斗放置在其機座上時，應確保機座已放在穩定的表面上。
6. 如果電熨斗發生跌落、有可見的損壞跡象或有滲漏現象，則這個電熨斗不能使用。請聯絡維修人員檢查或維修。
7. 當使用器具時，要注意防止蒸氣發生噴濺的危險。
8. 當為水箱注水和清潔時，應將電源插頭拔掉。

# 產品參數

產品名稱：二合一手提蒸氣熨斗掛燙機	產品型號：TGS150
額定電壓：220-240V~	額度頻率：50 – 60 Hz
額度功率：1370 – 1630 W	水箱容量：約 800 ml
產品尺寸：約 220 (深) x 145 (寬) x 282 (高) (毫米)	

# 電路原理圖

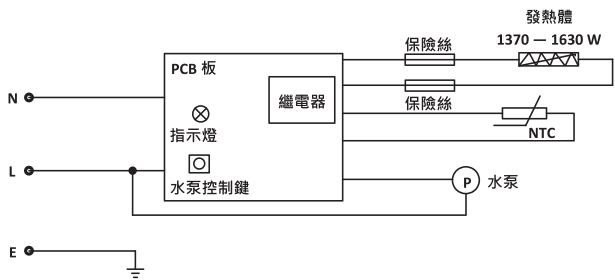

電氣原理圖僅供參考，如有改動恕不另行通知



## 產品結構部件

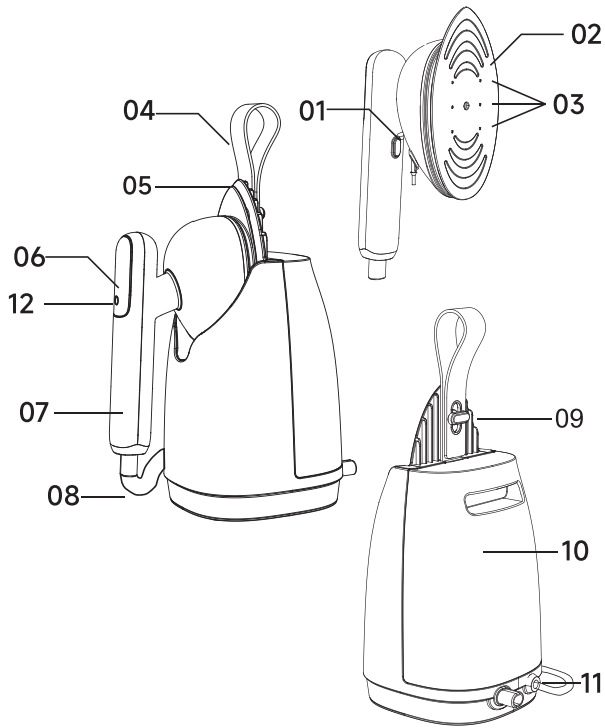

01. 蒸氣按鍵

04. 提手

07. 手柄

10. 水箱

02. 熨燙面板

05. 托架

08. 蒸氣管

11. 電源線

03. 出氣孔

06. 顯示窗

09. 提手旋鈕

12. 功能鍵

# 使用說明

1. 向上取出水箱後，打開水箱塞加水約 800 ml，在加水過程中，請留意水箱口的水位變化，切勿注入過量的水，以免溢出。加完水後，蓋好水箱塞後把水箱安裝回主體上。



2. 將電源插頭插上電源插座，並使用有接地線的電源。插上電源線插頭，手柄上的六個檔位圖標及文字會長亮，此時為待機狀態。長時間沒有任何操作，按鍵則進入關機狀態(六個檔位的圖標熄滅)，再次觸摸功能鍵則進入「乾燙」(Iron)檔位。
3. 取下噴頭，輕觸一下功能鍵，「乾燙」檔位閃爍，其它 5 檔圖標全亮，幾秒後其它 5 個圖標會燈滅，機器進入預熱狀態，機內發熱線開始預熱，預熱完成後「乾燙」檔位會長亮，進入「乾燙」模式。



向下取下噴頭



輕觸功能鍵



乾燙檔位閃爍

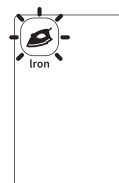

乾燙檔位常亮

4. 蒸氣功能：

預熱完成後，觸摸一下功能鍵，「羊毛」(Wool) 檔位閃爍；

按一下手柄底下的蒸氣按鍵，羊毛檔位變常亮，水泵開始操作，噴頭噴出蒸氣；再按一下手柄底下的蒸氣按鍵，羊毛檔位變回閃爍，水泵停止操作，噴頭停止噴出蒸氣；

同樣操作方式，在預熱完成後輕觸功能鍵可以切換其它蒸氣檔位，切換到當前蒸氣檔位閃爍，按手柄底下的蒸氣按鍵，噴頭會噴蒸氣；在任何蒸氣檔位閃爍或常亮狀態下都可以輕觸功能鍵來切換檔位；

功能鍵的預設檔位操作順序是：乾燙(Iron)→羊毛(Wool)→棉麻(Linen)→混紡(Blend)→絲綢(Silk)→乾燙(Iron)..... 以此循環。

## 5. 清洗功能：

當預熱完成後，在任一檔位同時長按住功能鍵和蒸氣按鍵 3 秒，清洗檔會常亮並即進入清洗模式，水與蒸氣的混合物持續噴出約一分鐘左右，然後等待約 15 秒左右，發熱體會蒸乾內部殘留水份，然後會關機進入待機狀態；清洗功能啟動後，按一下蒸氣按鍵可以結束清洗功能，進入待機狀態。

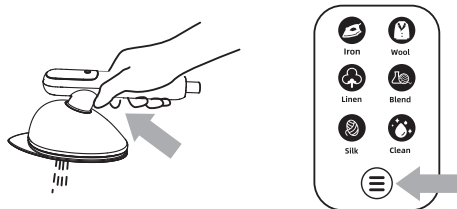

注意

在清洗模式的過程中發熱體持續操作，並且會有大量的水從熨燙面板噴出，請在使用清洗功能前將水箱加滿水，並準備好用來裝水的容器，機器運作時小心燙傷。

## 6. 爆炸蒸氣 (強力蒸氣) 功能：

當機器處於乾燙檔位時，1 秒內連按兩下蒸氣按鍵，此時強力蒸氣模式會啟動，水泵會抽水並噴出蒸氣，六個功能圖示會閃爍幾秒 (以呼吸燈形式)，然後機器回到乾燙檔位。強力蒸氣功能結束後，必須隔 15 秒才可以啟動下一次強力蒸氣功能。

## 7. 缺水提示功能：

在蒸氣模式下，如監測到水量不足或水泵乾抽時，燈光會不停閃爍 (以跑馬燈形式)，請往水箱加水，當水量回復正常後即可解除缺水提示。

## 8. 機件保護功能：

機器在持續 10 分鐘內沒有任何操作或不按任何按鍵，整機會關機，機器會回到待機狀態。

## 9. 當機器處於任何一個工作的狀態下，長按功能鍵，整機會停止工作，機器會回到待機狀態。

## 使用時注意事項

1. 此款產品噴頭出氣口溫度比較高，最高可達到 170°C，因此，在使用前請先確認衣物的物料特性及衣物上的護理標籤，請勿長時間停留在同一位置，以免損壞衣物。
2. 在不使用此產品時，請倒掉或用完水箱內的水，直至無蒸氣噴出後，才可以關閉蒸氣開關後拔掉電源插頭。如果在噴頭還有蒸氣噴出時，關閉蒸氣開關切斷電源，此時發熱體裡還剩餘有水，加上發熱體還有餘熱，會不定時有少量蒸氣噴出，請不要讓噴頭對著別人，避免造成蒸氣燙傷。
3. 收納前請倒掉或用完水箱內的水，直至機器無蒸氣噴出後才關機，然後拔掉電源插頭，待產品完全冷卻後再收納。
4. 不使用機器期間，避免長期使用吊帶懸掛機器。
5. 噴頭放置於機身時的正確方向為顯示幕向上(如圖所示)。

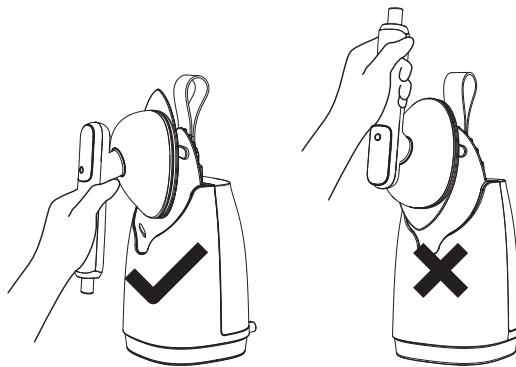

## 清潔保養

1. 使用本機器時請勿添加任何洗滌劑，請只加入清水。如果電線有損壞或者機器不能正常操作，聯繫客戶服務更換零件，請勿試圖自行拆卸修換。
2. 在清理本機之前，請關機把插頭拔出並且待機身完全冷卻。
3. 在使用完產品後，倒掉水箱內的水並按到產品沒有蒸氣噴出為止。
4. 請勿把本機器放入水中，請用乾布擦乾機身，無需用特別的清潔劑去清洗，長時間使用後，如出氣面板有異物，關機拔掉插頭並待機器冷卻後，使用濕布擦淨即可。
5. 確保本機在完全風乾或擦乾後才儲存或包裝。
6. 產品收納的方法：

- i) 將電源綫和蒸氣管用硅膠扎帶整理好。

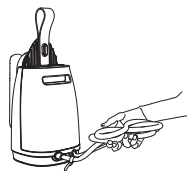

- ii) 將提手旋鈕向左邊旋轉至「垂直」，解開提手。



- iii) 將電源綫和蒸氣管放入提手內側，將提手旋鈕向右旋轉至「橫向」。



備註：提手旋鈕的旋轉有方向性，請按上圖的旋轉方向進行操作。

## 常見問題及維護

故障現象	分析原因	故障排除
完全不工作， 指示燈不亮。	電源線插頭未插在電源上	將電源線插頭 連接電源
	電源板已損壞	聯繫客戶服務更換零件。
本機不能噴出蒸 氣，但開關指示燈 亮起。	水箱沒有加水	向水箱中注入適量的水
	機器固障	聯繫客戶服務更換零件。
	恆溫器損壞	
噴頭底板發熱可正 常使用，指示燈不 亮	指示燈壞了	聯繫客戶服務更換零件。
蒸氣量過少	電壓過低	請避免在用電高峰 時段使用本產品
噴頭噴水	開機有少量水噴出	屬於正常現象， 約一分鐘後消失
	發熱體不工作	聯繫客戶服務更換零件。
水箱漏水	水箱破裂	把水箱的蓋子蓋好
		聯繫客戶服務更換零件。
整機漏水	機裡的水管道損壞	聯繫客戶服務更換零件。
水箱變形	使用時加入高溫熱水	聯繫客戶服務更換零件。

# 2-in-1 Handheld Garment Steamer

## User Manual

**Model : TGS150**

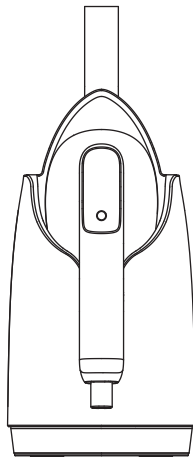

- Please read this user manual thoroughly before using the product and store it safely for future reference.
- In case of any changes in the product's appearance or color, the actual product shall prevail.
- For any technical updates or modifications, please refer to the latest version of the user manual.

# Welcome

Thank you for choosing our product. To ensure proper usage, please read this manual thoroughly before operating the device. We recommend keeping it together with your purchase invoice for future reference.

## Contents

1.	Safety and Precautions	· · · · ·	1
2.	Product Specifications	· · · · ·	2
3.	Electrical Diagram	· · · · ·	2
4.	Product Structure and Components	· · · · ·	3
5.	Operation Instructions	· · · · ·	4
6.	Cleaning and Maintenance	· · · · ·	7
7.	FAQs and Troubleshooting	· · · · ·	8



# Safety and Precautions

Before use, please read the instruction manual thoroughly and follow all guidelines strictly during operation. New users should take note of the following precautions:

1. Use the correct power supply: 220–240V~ 50–60Hz. Connecting to an incorrect voltage may damage the device.
2. Do not operate the product outside its specified usage range.
3. Avoid sharing the same power outlet with high-power appliances.
4. Keep children, individuals with cognitive impairments, or persons with disabilities away from the device during use.
5. This product is not a toy and should not be used for play by children.
6. Always supervise the device when it is powered on or heating. Please do not leave this product idle.
7. If the product is dropped, or if the power cord, plug, or steam pipe shows visible damage, do not attempt repairs yourself. Contact customer service or qualified technician for replacement.
8. Before use, fill the water tank completely. Monitor the water level during operation and refill as needed.
9. Please do not add water above 40°C or any liquid other than clean water into the water tank.
10. Do not use the steam nozzle directly on people, animals, or clothing being worn.
11. Avoid touching the soleplate or steam during operation to prevent burns.
12. Keep the power cord away from heated surfaces. Do not allow it to come into contact with hot components.
13. Prevent the power cord from touching sharp objects. When unplugging, grip the plug firmly—do not pull the cord.
14. After use, unplug the power cord following proper procedures.
15. Keep the device away from flammable materials and chemicals.
16. Do not immerse the steam head in water.
17. To prevent electric shock or other hazards, always turn off the device before cleaning or when not in use.

## Warnings:

1. If the power cord is damaged, it must be replaced by the manufacturer, its service center, or qualified personnel to avoid hazards. If components such as the fuse, circuit board, or heating system are damaged or malfunctioning, they must also be replaced by professionals.
2. Do not leave the appliance unattended while it is connected to the power supply.
3. Always unplug the power cord before filling the water tank.
4. The steamer must be used and placed on a stable surface.
5. When placing the steamer on its base, ensure the base is on a stable surface.
6. Do not use the steamer if it has been dropped, shows visible damage, or is leaking. Please contact customer services for inspection or repair.
7. Be cautious of steam splashes during use.
8. Unplug the power cord before filling the water tank or cleaning the appliance.

# Product Specifications

Product Name:	2-in-1 Handheld Garment Steamer	Model:	TGS150
Rated Voltage:	220-240V~	Rated Frequency:	50 – 60 Hz
Rated Power:	1370 – 1630 W	Water Tank Capacity:	Around 800 ml
Product Dimensions:	Approximate 220 (Depth) x 145 (Width) x 282 (Height) (mm)		

## Electrical diagram

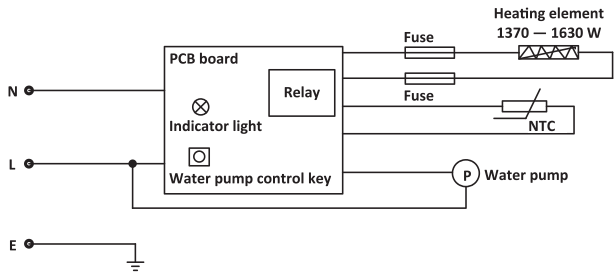

The electrical schematic diagram is provided for reference purposes only. Any modifications or updates to the diagram may occur without prior notice.

# Product Structural Components

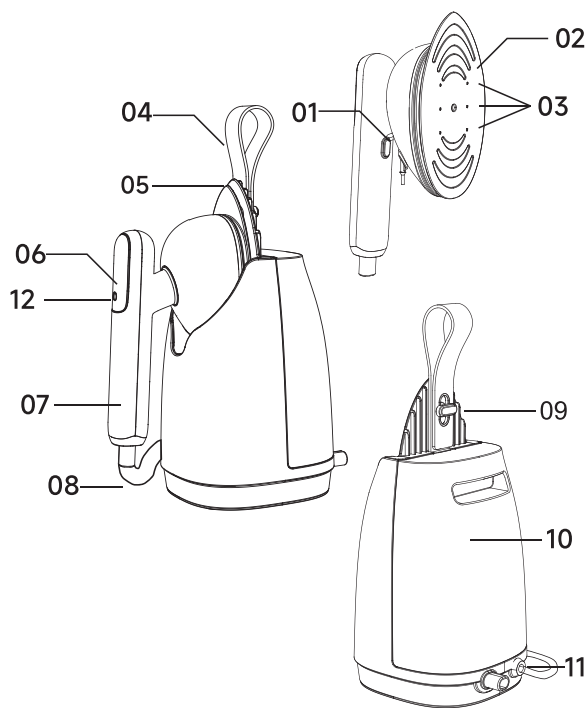

- |                       |                   |                  |
|-----------------------|-------------------|------------------|
| 01. Steam switch      | 05. Bracket       | 09. Handle knob  |
| 02. Ironing panel     | 06. Display Panel | 10. Water tank   |
| 03. Steam outlet hole | 07. Handle        | 11. Power cord   |
| 04. Sling             | 08. Steam tube    | 12. Function key |

# Operation Instructions

1. After lifting up the water tank, open the tank cap and fill it with approximately 800 ml of water. During the filling process, pay close attention to the water level at the tank opening and avoid overfilling to prevent overflow. Once filled, securely close the tank cap and reinstall the water tank onto the main unit.



2. Insert the power plug into the power outlet. Once the power cord is plugged in, the six setting icons on the handle will remain illuminated, indicating standby mode. If no operating for an extended period, the appliance will automatically switch to power-off mode (icons will turn off). Touching the function key again will activate the “Iron” mode.
3. Take out the spray head and tap the function key. The “Iron” indicator will start flashing, while the other five mode icons light up. After a few seconds, the five icons will turn off, and the appliance will enter the preheating phase. During this time, the internal heating element activates to preheat. Once preheating is completed, the “Iron” indicator remains steadily lit, indicating that the device is now in “Iron” mode.

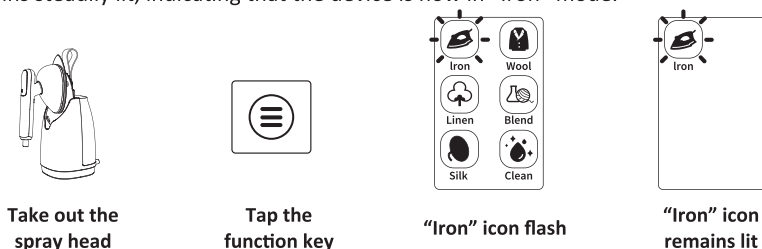

4. Steam function:

After preheating is complete, tap the function key. The “Wool” mode icon will begin flashing. Press the steam switch located under the handle. The “Wool” icon will turn solid, the water pump activates, and steam is released from the nozzle. Press the steam switch again to stop steaming. The “Wool” icon will return to flashing, the pump stops, and steam output ceases.

User can change to other steam modes by tapping the function key after preheating. The selected mode icon will flash. Press the steam switch to begin steaming in that mode. User can switch between steam modes at any time by tapping the function key, whether the icon is flashing or solid.

Function Key Mode Sequence:

Iron (Startup) → Wool → Linen → Blended → Silk → Iron.

The modes cycle in this order with each tap of the function key.

5. Cleaning function:

After preheating is complete, press and hold both the function button and the steam button for 3 seconds on any setting. The cleaning indicator will stay lit and the device will enter cleaning mode. A mixture of water and steam will be continuously sprayed for about one minute. Then, after waiting for approximately 15 seconds, the heating element will evaporate any remaining water inside. The device will then shut down and enter standby mode. Once the cleaning function is activated, pressing the steam button once will end the cleaning process and return the device to standby mode.

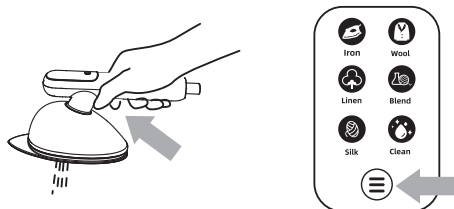

**Attention**

**During the cleaning mode, the heating element will keep working, and a large amount of water will be sprayed from the ironing panel. Please fill the water tank before using the cleaning function and prepare a container to collect the water. Be cautious of burns while the machine is operating.**

6. Explosion steam (Power steam) function:

When the machine is in dry ironing mode, press the steam button twice within one second to activate the Power Steam mode. The water pump will draw water and release steam. Six function icons will flash for a few seconds in a breathing light pattern. After that, the machine will return to dry ironing mode. Note: After Power Steam ends, you must wait for 15 seconds before activating it again.

7. Water shortage alert function:

In steam mode, if low water level or dry pumping is detected, the indicator lights will continuously flash in a marquee pattern. Please refill the water tank. Once the water level returns to normal, the low water warning will be cleared.

8. Protection function:

If the machine remains idle for 10 consecutive minutes without any operation or button press, it will automatically shut down and enter to standby mode.

9. While the machine is operating in any mode, press and hold the function button to stop all operations and return to standby mode.

## Precautions

1. The nozzle outlet temperature can reach up to 170°C. Before use, check the fabric type and care label of your clothing. Do not keep the nozzle in one spot for too long to avoid damage.
2. When not in use, empty the water tank or use up the remaining water. Wait until no steam is emitted, then turn off the steam switch and unplug the power cord. If steam is still coming out when powered off, residual water and heat in the heating element may cause intermittent steam release. Do not point the nozzle at people to prevent burns.
3. Before storage, empty or use up the water in the tank. Wait until no steam is emitted, then turn off the machine and unplug the power cord. Store the product only after it has completely cooled down.
4. Avoid hanging the machine by its strap for extended periods when not in use.
5. When placing the nozzle on the main unit, ensure the display panel is facing upward (as shown in the diagram).

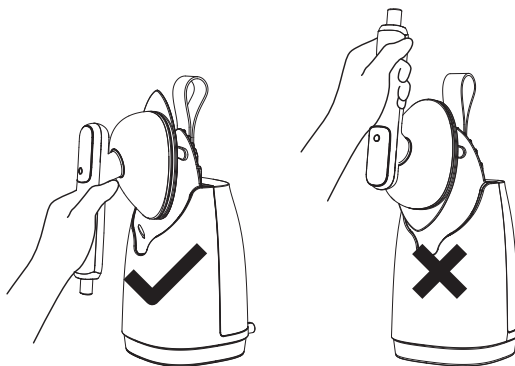

# Cleaning and Maintenance

1. Do not add any detergent when using this machine. Please use clean water only. If the wiring is damaged or the machine malfunctions, please contact customer service for parts replacement. Do not attempt to disassemble or repair the device yourself.
2. Before cleaning the device, ensure it is turned off, unplugged, and has fully cooled down.
3. After using the product, empty the water tank and press the button until no more steam is released.
4. Do not immerse the machine in water. To clean the exterior, use a dry cloth and avoid using any specialized cleaning agents. After extended use, if foreign objects accumulate on the exhaust panel, turn off the machine, unplug it, and allow it to cool completely before wiping the panel with a damp cloth.
5. Ensure the device is completely dried or wiped dry before storing or packaging.
6. Product Storage Guide :

- i) Ensure the power cord and steam pipe are correctly routed and organized with the silicone tape.

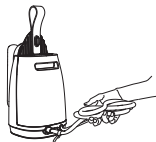

- ii) Turn the handle knob to the left until it reaches the "Vertical" position, then unlock the handle.



- iii) Place the power cord and steam pipe into the handle, then rotate the handle knob to the right until it reaches the 'Horizontal' position.

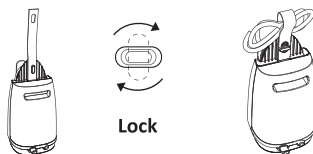

Remarks:

The handle knob has a specific rotation direction. Please operate it according to the direction shown in the diagram above.

# FAQs and Troubleshooting

Fault	Cause	Solution
Indicator light is not on	The plug is not connected to the power supply	Connect the Plug to power socket
	Circuit board is damaged	Contact customer service to replace the parts.
This machine cannot spray steam, but the switch indicator light is on	No water in water tank	Fill appropriate amount of water into water tank
	Machine malfunction	Contact customer service to replace the parts.
	Thermostat is damaged	
Bottom plate is heating up normally, but no indicating light	Indicating light is damaged	Contact customer service to replace the parts.
Low steam rate	Low supply voltage	Please avoid using this product during peak electricity usage hours
Unexpected water sprays from nozzle	Small amount of water sprays out when power on	It is a normal phenomenon and stop around one minute later
	Heating element is not working	Contact customer service to replace the parts.
Water tank leaking	Water tank is cracked or damaged	Close the lid of the water tank properly
		Contact customer service to replace the parts.
Water leaking from the machine	The water pipeline inside the machine is damaged	Contact customer service to replace the parts.
Water tank deformed	Hot water was filled into water tank	Contact customer service to replace the parts.





